

**Table of Contents**

<b>Index Number</b>	<b>City Designation</b>	<b>Location Description</b>	<b>Page Number</b>
<b>Permanent High Accuracy Control Points (PHAC)</b>			
	PHAC 1	City of Wheat Ridge City Hall Park	5
	PHAC 2	North of 32nd Dr & Union St	6
	PHAC 3	Southwest of 45th Ave & Vance St	7
	PHAC 4	East of 47th Pl & Miller St	8
<b>Aliquot Corners</b>			
6-H	160003	16th Corner at 35th Ave & Youngfield St	20
8-G	160004	16th Corner at 32nd Ave & Union St	27
13-H	160005	16th Corner at 35th & Kipling St	42
13-K	160006	16th Corner at 40th Extended & Kipling St	44
19-H	160007	16th Corner at 35th & Wadsworth Blvd	62
19-K	160008	16th Corner at 41st Ave & Wadsworth Blvd	64
19-M	160009	16th Corner at 46th Ave & Wadsworth Blvd	66
21-F	160010	16th Corner at 29th Ave & Pierce St	70
22-F	160011	16th Corner at 29th Ave & Lamar St	76
23-K	160013	16th Corner at 41st Ave & Harlan St	81
<b>Section 13</b>			
21-N	13809	48th Ave & Pierce St	74
21-P	12809	52nd Ave & Pierce Extended	75
23-N	13909	48th Ave & Harlan St	83
23-P	12909	52nd Ave & Harlan Extended	84
<b>Section 14</b>			
17-N	13609	48th Ave Extended & Carr St	58
17-P	12609	52nd Ave & Carr St	59
19-N	13709	48th Ave & Wadsworth Boulevard	67
19-P	12709	52nd Ave & Wadsworth Blvd	68
21-N	13809	48th Ave & Pierce St	74
21-P	12809	52nd Ave & Pierce Extended	75
<b>Section 15</b>			
13-N	13409	48th Ave Extended and Kipling St	46
13-P	12409	52nd Ave Extended & Kipling St	47
15-N	13509	48th Ave Extended & Garrison St	52
15-P	12509	52nd Ave & Garrison St	53
17-N	13609	48th Ave & Carr St	58

17-P	12609	52nd Ave & Carr St	59
<b>Section 16</b>			
9-N	13209	48th Ave & Simms St Extended	32
9-P	12709	52nd Ave & Simms St Extended	33
11-N	13309	48th Ave & Oak St Extended	38
11-P	12309	52nd Ave & Oak St Extended	39
13-N	13409	48th Aven Extended & Kipling St	46
13-P	12409	52nd Ave & Kipling St	47
<b>Section 17</b>			
5-P	12009	52nd Ave & Alkire St	18
7-N	13109	48th Ave & Ward Rd	25
7-P	12109	52nd Ave & Ward Rd	26
9-N	13209	48th Ave & Simms St Extended	32
9-P	12209	52nd Ave & Simms St Extended	33
<b>Section 19</b>			
3-L	14001	44th Ave & Eldridge St	10
3-N	13001	48th Ave & Eldridge St	11
5-J	15009	38th Ave Extended & Alkire Extended	15
5-L	14009	44th Ave Extended & Alkire Extended	16
5-N	13009	48th Ave Extended & Alkire Extended	17
<b>Section 20</b>			
5-L	14009	44th Extended & Alkire Extended	16
7-J	15109	38th Ave & Ward Rd	23
7-L	14109	44th Ave Extended & Ward Extended	24
7-N	13109	48th Ave & Ward Rd Extended	25
9-J	15209	38th Ave & Simms St Extended	30
9-L	14209	44th Ave Extended & Simms St Extended	31
9-N	13209	48th Ave & Simms St Extended	32
<b>Section 21</b>			
9-J	15209	38th Ave & Simms St Extended	30
9-L	14209	44th Ave & Extended & Simms Extended	31
9-N	13209	48th Ave & Simms St Extended	32
11-J	15309	38th Ave & Simms St Extended	36
11-L	14309	44th Ave Extended & Oak Extended	37
11-N	13309	48th Ave Extended & Oak Extended	38
13-J	15409	38th Ave & Kipling St	43
13-L	14409	44th Ave Extended & Kipling St	45
13-N	13409	48th Ave Extended & Kipling St	46
<b>Section 22</b>			
13-J	15409	38th Ave & Kipling St	43
13-L	14409	44th Ave Extended & Kipling St	45

13-N	13409	48th Ave Extended & Kipling St	46
15-J	15509	38th Ave & Kipling St	50
15-L	14509	38th Ave & Garrison St	51
15-N	13509	48th Ave Extended & Garrison St	52
17-J	15609	38th Ave & Carr St	56
17-L	14609	44th Ave & Carr St	57
17-N	13609	48th Ave Extended & Carr St	58

#### Section 23

17-J	15609	38th Ave & Carr St	56
17-L	14609	44th Ave & Carr St	57
17-N	13609	48th Ave Extended & Carr St	58
19-J	15709	38th Ave & Wadsworth Blvd	63
19-L	14709	44th Ave & Wadsworth Blvd	65
19-N	13709	48th Ave Extended & Wadsworth Blvd	67
21-J	15809	38th Ave & Pierce St	72
21-L	14809	44th Ave & Pierce St	73
21-N	13809	48th Ave & Pierce St	74

#### Section 24

21-J	15809	38th Ave & Pierce St	72
21-L	14809	44th Ave & Pierce St	73
21-N	13809	48th Ave & Pierce St	74
23-J	15909	38th Ave & Harlan St	80
23-L	14909	44th Ave & Harlan St	82
23-N	13909	48th Ave & Harlan St	83
25-J	15901	38th Ave & Sheridan Blvd	87
25-L	14901	44th Ave & Sheridan Blvd	88

#### Section 25

21-E	16881	26th Ave & Pierce St	69
21-G	16809	32nd Ave and Pierce St	71
21-J	15809	38th Ave & Pierce St	72
23-E	16981	26th Ave & Harlan St	77
23-G	16909	32nd Ave & Harlan St	79
23-J	15909	38th Ave & Harlan St	80
25-E	16973	26th Ave & Sheridan Blvd	85
25-G	16901	32nd Ave & Sheridan Blvd	86
25-J	15901	38th Ave & Sheridan Blvd	87

#### Section 26

17-E	16681	26th Ave & Carr St	54
17-G	16609	32nd Ave & Carr St Extended	55
17-J	15609	38th Ave & Carr St	56
19-E	16781	26th Ave & Wadsworth Blvd	60
19-G	16709	32nd Ave & Wadsworth Blvd	61
19-J	15709	38th Ave & Wadsworth Blvd	63

21-E	16881	26th Ave & Pierce St	69
21-G	16809	32nd Ave & Pierce St	71
21-J	15809	38th Ave & Pierce St	72

#### Section 27

13-E	16481	26th Ave & Kipling St	40
13-G	16409	32nd Ave & Kipling St	41
13-J	15409	38th Ave & Kipling St	43
15-E	16581	26th Ave & Garrison St	48
15-G	16509	32nd Ave & Garrison St	49
15-J	15909	38th Ave & Garrison St	50
17-E	16681	26th Ave & Carr St	54
17-G	16609	32nd Ave & Carr Extended	55
17-J	15609	38th Ave & Carr St	56

#### Section 28

9-E	16281	26th Ave & Simms St	28
9-G	16209	32nd Ave & Simms St	29
9-J	15209	38th Ave & Simms Extended	30
11-E	16381	26th Ave & Oak St	34
11-G	16309	32nd Ave & Oak St	35
11-J	15309	38th Ave & Oak St	36
13-E	16481	26th Ave & Kipling St	40
13-G	16409	32nd Ave & Kipling St	41
13-J	15409	28th Ave & Kipling St	43

#### Section 29

5-E	16081	26th Ave & Alkire St	13
5-G	16009	32nd Ave & Alkire St	14
7-E	16181	26th Ave Extended & Ward Rd Extended	21
7-G	16109	32nd Ave & Ward Rd	22
7-J	15109	38th Ave & Ward Rd	23
9-E	16281	26th Ave & Simms St	28
9-G	16209	32nd Ave & Simms St	29
9-J	15209	38th Ave & Simms Extended	30

#### Section 30

3-E	16002	26th Ave & Eldridge St	9
5-E	16081	26th Ave & Alkire St	13
5-G	16009	32nd Ave & Pierce St	14
21-N	13809	48th Ave & Pierce St	74
21-P	12809	52nd Ave & Pierce St Extended	75
23-N	13909	48th Ave & Harlan St	83
23-P	12909	52nd Ave & Harland St Extended	84

## Designation: PHAC-1 – Permanent High Accuracy Point No. 1

(SPCS) State Plane Coordinate System, Colorado Central

FIPSZONE: 502      ADSZONE: 3476      UTM ZONES: 12 & 13

State/County:      Colorado/Jefferson

Horizontal System:      NAD 83/92 (NAD83 with 1992 High Accuracy Reference Network adjustment)

Ellipsoid:      WGS 84 – (World Geodetic System of 1984)

Vertical Datum:      NAVD 88 – (North American Vertical Datum of 1988)

NGS Unpublished (City of Wheat Ridge Surveyed Point)

Combined Factors:      0.999747803 (ground to grid)  
1.00025226062 (grid to ground - City Datum)      (Millions truncated in City Datum)

FGCC Horizontal & Vertical Accuracy: Second Order, Class I / NGS Stability Classification: B

Monument last recovered: October 25, 2019

	<u>Latitude</u>	<u>Longitude</u>
Position:	39°45'28.83495"N	105°04'46.27094"W
Ellipsoid Height:	1651.11	

	<u>Northing</u>	<u>Easting</u>
SPCS:	1701258.7500	3118217.5810
City Datum:	701687.9106	119004.1845
Height:	5471.62      (US) Feet (Adjusted)	

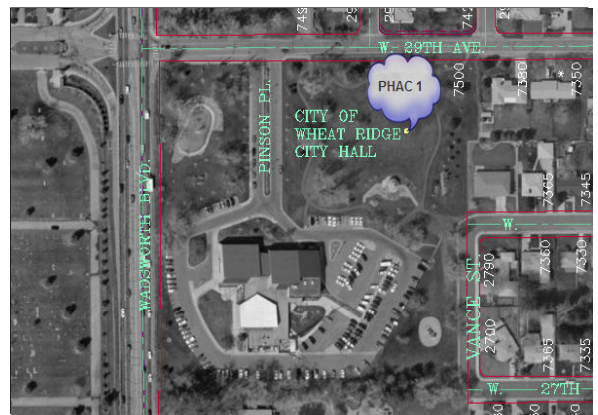

The station is located in the City of Wheat Ridge, in the Southeast 1/4 of Section 26, T3S, R69W, of the 6th Principal Meridian.

To reach the station, travel to the intersection of 29th Avenue & Wadsworth. Travel eastward to Pinson Place, and turn south into Wheat Ridge City Hall. The monument is located approx. 100' northeast of the gazebo in Hayward Park.

**Designation: PHAC-2 – Permanent High Accuracy Point No. 2**

(SPCS) State Plane Coordinate System, Colorado Central

FIPSZONE: 502      ADSZONE: 3476      UTM ZONES: 12 & 13

State/County:      Colorado/Jefferson

Horizontal System:      NAD 83/92 (NAD83 with 1992 High Accuracy Reference Network adjustment)

Ellipsoid:      WGS 84 – (World Geodetic System of 1984)

Vertical Datum:      NAVD 88 – (North American Vertical Datum of 1988)

NGS Unpublished (City of Wheat Ridge Surveyed Point)

Combined Factors:      0.999747803 (ground to grid)  
1.00025226062 (grid to ground - City Datum)      (Millions truncated in City Datum)

FGCC Horizontal & Vertical Accuracy: Second Order, Class I / NGS Stability Classification: B

Monument last recovered: October 25, 2019

	<u>Latitude</u>	<u>Longitude</u>
Position:	39°45'47.42626"N	105°07'59.12542"W
Ellipsoid Height:	1651.11	

	<u>Northing</u>	<u>Easting</u>
SPCS:	1703074.6550	3103148.7300
City Datum:	703504.2737	103931.5322
Height:	5451.56	(US) Feet (Adjusted)



The station is located in the City of Wheat Ridge, in the Northeast 1/4 of Section 29, T3S, R69W, of the 6th Principal Meridian.

To reach the station, travel to the intersection of W. 32nd Ave. & Union St. Travel northward to W. 32nd Dr. & Union St., to Lewis Meadows park entrance. The monument is located approx. 60' north of the Lewis Meadows Park sign.





**Designation: PHAC-3 – Permanent High Accuracy Point No. 3**

(SPCS) State Plane Coordinate System, Colorado Central

FIPSZONE: 502      ADSZONE: 3476      UTM ZONES: 12 & 13

State/County:      Colorado/Jefferson

Horizontal System:      NAD 83/92 (NAD83 with 1992 High Accuracy Reference Network adjustment)

Ellipsoid:      WGS 84 – (World Geodetic System of 1984)

Vertical Datum:      NAVD 88 – (North American Vertical Datum of 1988)

NGS Unpublished (City of Wheat Ridge Surveyed Point)

Combined Factors:      0.999747803 (ground to grid)  
1.00025226062 (grid to ground - City Datum)      (Millions truncated in City Datum)

FGCC Horizontal & Vertical Accuracy: Second Order, Class I / NGS Stability Classification: B

Monument last recovered: October 25, 2019

	<u>Latitude</u>	<u>Longitude</u>
Position:	39°46'41.99172"N	105°04'47.12949"W
Ellipsoid Height:	1625.62	

	<u>Northing</u>	<u>Easting</u>
SPCS:	1708660.8670	3118116.2880
City Datum:	709091.8948	118902.8659
Height:	5388.09	(US) Feet (Adjusted)



The station is located in the City of Wheat Ridge, in the Northeast 1/4 of Section 23, T3S, R69W, of the 6th Principal Meridian.

To reach the station, travel to the intersection of W. 45th Ave. & Vance St. Travel westward to the entrance to the Park (150'). The monument is located approx. 20' southwest of the intersection of the sidewalks at the park entrance.

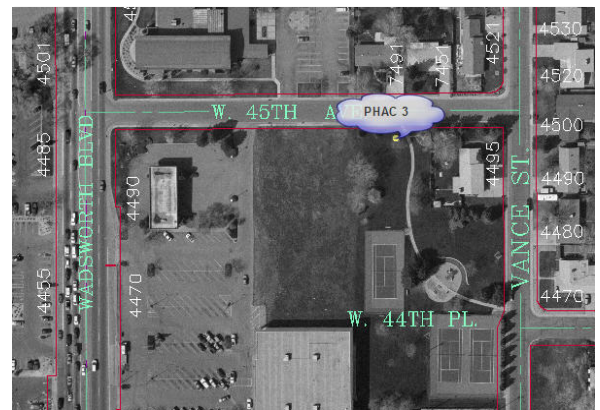

**Designation: PHAC-4 – Permanent High Accuracy Point No. 4**

(SPCS) State Plane Coordinate System, Colorado Central

FIPSZONE: 502      ADSZONE: 3476      UTM ZONES: 12 & 13

State/County:      Colorado/Jefferson

Horizontal System:      NAD 83/92 (NAD83 with 1992 High Accuracy Reference Network adjustment)

Ellipsoid:      WGS 84 – (World Geodetic System of 1984)

Vertical Datum:      NAVD 88 – (North American Vertical Datum of 1988)

NGS Unpublished (City of Wheat Ridge Surveyed Point)

Combined Factors:      0.999747803 (ground to grid)  
1.00025226062 (grid to ground - City Datum)      (Millions truncated in City Datum)

FGCC Horizontal & Vertical Accuracy: Second Order, Class I / NGS Stability Classification: B

Monument last recovered: October 25, 2019

	<u>Latitude</u>	<u>Longitude</u>
Position:	39°46'57.36407"N	105°06'50.59074"W
Ellipsoid Height:	1621.96	

	<u>Northing</u>	<u>Easting</u>
SPCS:	1710173.5710	3108470.5910
City Datum:	710604.9804	109254.7357
Height:	5375.38      (US) Feet (Adjusted)	



The station is located in the City of Wheat Ridge, in the Northeast 1/4 of Section 21, T3S, R69W, of the 6th Principal Meridian.

To reach the station, travel to the intersection of W. 47th Avenue & Miller St. Turn into the parking lot of Fruitdale Park. The monument is located approx. 10' west of the northwest corner of the parking lot.





## City of Wheat Ridge Survey Monument

**City Designation: POINT 16002**

**Monument Description:** South 1/4 Corner Section 30, T3S, R69W, of the 6th Principal Meridian.

(SPCS) State Plane Coordinate System, Colorado Central

FIPZONE: 502      ADSZONE: 3476      UTM ZONES: 12 & 13

State/County:      Colorado/Jefferson

Colorado Land Survey Master Index Number:      3-E

Horizontal Datum: NAD 83/92 – HARN (High Accuracy Reference Network) Based

Ellipsoid:      WGS 84 – (World Geodetic System of 1984)

Vertical Datum:      NAVD 88 – (North American Vertical Datum of 1988)

NGS Unpublished (City of Wheat Ridge Surveyed Point)

Combined Factors: 0.999747803 (ground to grid)

1.00025226062 (grid to ground - City Datum)

	<u>Northing</u>	<u>Easting</u>	
<u>SPCS:</u>	1699896.9463	3096574.9678	
<u>City Datum:</u>	700325.7633	97356.1117	(Millions truncated in City Datum)
<u>Height:</u>	5608.15	US Feet (Adjusted)	



The monument is located in Unincorporated Jefferson County Colorado in the intersection of W. 26th Ave. and Eldridge St.



# City of Wheat Ridge Survey Monument

**City Designation: POINT 14001**

**Monument Description:** Center 1/4 Corner Section 19, T3S, R69W, of the 6th Principal Meridian.

(SPCS) State Plane Coordinate System, Colorado Central

FIPZONE: 502      ADSZONE: 3476      UTM ZONES: 12 & 13

State/County:      Colorado/Jefferson

Colorado Land Survey Master Index Number:      3-L

Horizontal Datum: NAD 83/92 – HARN (High Accuracy Reference Network) Based

Ellipsoid:      WGS 84 – (World Geodetic System of 1984)

Vertical Datum:      NAVD 88 – (North American Vertical Datum of 1988)

NGS Unpublished (City of Wheat Ridge Surveyed Point)

Combined Factors: 0.999747803 (ground to grid)

1.00025226062 (grid to ground - City Datum)

	<u>Northing</u>	<u>Easting</u>	
<u>SPCS:</u>	1707815.6828	3096481.4915	
<u>City Datum:</u>	708246.4974	97262.6118	(Millions truncated in City Datum)
<u>Height:</u>	5519.05	US Feet (Adjusted)	



The monument is located in unincorporated Jefferson County, Colorado in the intersection of W. 44th Ave. and Eldridge St.



## City of Wheat Ridge Survey Monument

**City Designation: POINT 13001**

**Monument Description:** South 1/4 Corner Section 19, T3S, R69W, of the 6th Principal Meridian.

(SPCS) State Plane Coordinate System, Colorado Central

FIPZONE: 502      ADSZONE: 3476      UTM ZONES: 12 & 13

State/County:      Colorado/Jefferson

Colorado Land Survey Master Index Number:      3-N

Horizontal Datum: NAD 83/92 – HARN (High Accuracy Reference Network) Based

Ellipsoid:      WGS 84 – (World Geodetic System of 1984)

Vertical Datum:      NAVD 88 – (North American Vertical Datum of 1988)

NGS Unpublished (City of Wheat Ridge Surveyed Point)

Combined Factors: 0.999747803 (ground to grid)

1.00025226062 (grid to ground - City Datum)

	<u>Northing</u>	<u>Easting</u>	
<u>SPCS:</u>	1710465.8258	3096463.7891	
<u>City Datum:</u>	710897.3089	97244.9050	(Millions truncated in City Datum)
<u>Height:</u>	5525.14	US Feet (Adjusted)	



The monument is located in Unincorporated Jefferson County, Colorado in the intersection of W. 48th Ave. and Eldridge St.



## City of Wheat Ridge Survey Monument

**City Designation: POINT 12001**

**Monument Description:** Center of Section 18, T3S, R69W, of the 6th Principal Meridian.

(SPCS) State Plane Coordinate System, Colorado Central

FIPZONE: 502      ADSZONE: 3476      UTM ZONES: 12 & 13

State/County:      Colorado/Jefferson

Colorado Land Survey Master Index Number:      3-P

Horizontal Datum: NAD 83/92 – HARN (High Accuracy Reference Network) Based

Ellipsoid:      WGS 84 – (World Geodetic System of 1984)

Vertical Datum:      NAVD 88 – (North American Vertical Datum of 1988)

NGS Unpublished (City of Wheat Ridge Surveyed Point)

Combined Factors: 0.999747803 (ground to grid)

1.00025226062 (grid to ground - City Datum)

	<u>Northing</u>	<u>Easting</u>	
<u>SPCS:</u>	1713098.8055	3096449.7023	
<u>City Datum:</u>	713530.9529	97230.8146	(Millions truncated in City Datum)
<u>Height:</u>	5546.39	US Feet (Adjusted)	

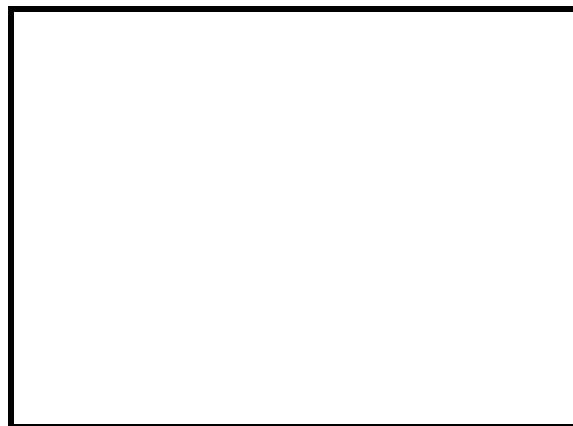

The monument is located in Unincorporated Jefferson County, Colorado at the intersection of W. 52nd Ave and Eldridge St.



## City of Wheat Ridge Survey Monument

**City Designation: POINT 16081**

**Monument Description:** Southeast 1/4 Corner Section 30, T3S, R69W, of the 6th Principal Meridian.

(SPCS) State Plane Coordinate System, Colorado Central

FIPSZONE: 502      ADSZONE: 3476      UTM ZONES: 12 & 13

State/County:      Colorado/Jefferson

Colorado Land Survey Master Index Number:      5-E

Horizontal Datum: NAD 83/92 – HARN (High Accuracy Reference Network) Based

Ellipsoid:      WGS 84 – (World Geodetic System of 1984)

Vertical Datum:      NAVD 88 – (North American Vertical Datum of 1988)

NGS Unpublished (City of Wheat Ridge Surveyed Point)

Combined Factors: 0.999747803 (ground to grid)

1.00025226062 (grid to ground - City Datum)

	<u>Northing</u>	<u>Easting</u>	
<u>SPCS:</u>	1699928.9430	3099212.0095	
<u>City Datum:</u>	700357.7681	99993.8186	(Millions truncated in City Datum)
<u>Height:</u>	5575.75	US Feet (Adjusted)	



The monument is located in Unincorporated Jefferson County Colorado in the intersection of W. 26th Ave. and Alkire St.





## City of Wheat Ridge Survey Monument

**City Designation: POINT 16009**

**Monument Description:** East 1/4 Corner Section 30, T3S, R69W, of the 6th Principal Meridian.

(SPCS) State Plane Coordinate System, Colorado Central

FIPZONE: 502      ADSZONE: 3476      UTM ZONES: 12 & 13

State/County:      Colorado/Jefferson

Colorado Land Survey Master Index Number:      5-G

Horizontal Datum: NAD 83/92 – HARN (High Accuracy Reference Network) Based

Ellipsoid:      WGS 84 – (World Geodetic System of 1984)

Vertical Datum:      NAVD 88 – (North American Vertical Datum of 1988)

NGS Unpublished (City of Wheat Ridge Surveyed Point)

Combined Factors: 0.999747803 (ground to grid)

1.00025226062 (grid to ground - City Datum)

	<u>Northing</u>	<u>Easting</u>	
<u>SPCS:</u>	1702572.9720	3099171.3543	
<u>City Datum:</u>	703002.4641	99953.1531	(Millions truncated in City Datum)
<u>Height:</u>	5530.74	US Feet (Adjusted)	

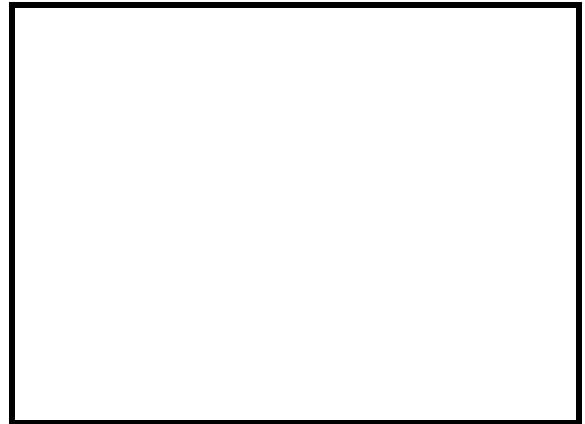

The monument is located in Unincorporated Jefferson County Colorado in the intersection of W. 32nd Ave. and Alkire St.



## City of Wheat Ridge Survey Monument

**City Designation: POINT 15009**

**Monument Description:** Southeast Corner Section 19, T3S, R69W, of the 6th Principal Meridian.

(SPCS) State Plane Coordinate System, Colorado Central

FIPZONE: 502      ADSZONE: 3476      UTM ZONES: 12 & 13

State/County:      Colorado/Jefferson

Colorado Land Survey Master Index Number:      5-J

Horizontal Datum: NAD 83/92 – HARN (High Accuracy Reference Network) Based

Ellipsoid:      WGS 84 – (World Geodetic System of 1984)

Vertical Datum:      NAVD 88 – (North American Vertical Datum of 1988)

NGS Unpublished (City of Wheat Ridge Surveyed Point)

Combined Factors: 0.999747803 (ground to grid)

1.00025226062 (grid to ground - City Datum)

	<u>Northing</u>	<u>Easting</u>	
<u>SPCS:</u>	1705213.4895	3099123.9026	
<u>City Datum:</u>	705643.6477	99905.6895	(Millions truncated in City Datum)
<u>Height:</u>	N/A	US Feet (Adjusted)	

No Image Available

No Image Available

This is a calculated position for Southeast Corner Section 19. No monument found or set. The location is in the City of Wheat Ridge, Colorado at the intersection of W. 38th Ave. extended and Alkire St. extended.



## City of Wheat Ridge Survey Monument

**City Designation: POINT 14009**

**Monument Description:** East 1/4 Corner Section 19, T3S, R69W, of the 6th Principal Meridian.

(SPCS) State Plane Coordinate System, Colorado Central

FIPSZONE: 502      ADSZONE: 3476      UTM ZONES: 12 & 13

State/County:      Colorado/Jefferson

Colorado Land Survey Master Index Number:      5-L

Horizontal Datum: NAD 83/92 – HARN (High Accuracy Reference Network) Based

Ellipsoid:      WGS 84 – (World Geodetic System of 1984)

Vertical Datum:      NAVD 88 – (North American Vertical Datum of 1988)

NGS Unpublished (City of Wheat Ridge Surveyed Point)

Combined Factors: 0.999747803 (ground to grid)

1.00025226062 (grid to ground - City Datum)

	<u>Northing</u>	<u>Easting</u>	
<u>SPCS:</u>	1707857.0747	3099130.3927	
<u>City Datum:</u>	708287.8998	99912.1812	(Millions truncated in City Datum)
<u>Height:</u>	5452.18	US Feet (Adjusted)	



The monument is located in the City of Wheat Ridge, Colorado in the intersection of W. 44th Ave. extended and Alkire St. extended (also being the northwest corner of the CDOT maintenance facility).



## City of Wheat Ridge Survey Monument

**City Designation: POINT 13009**

**Monument Description:** Northeast Corner Section 19, T3S, R69W, of the 6th Principal Meridian.

**(SPCS) State Plane Coordinate System, Colorado Central**

**FIPSZONE: 502    ADSZONE: 3476    UTM ZONES: 12 & 13**

**State/County:      Colorado/Jefferson**

**Colorado Land Survey Master Index Number:      5-N**

**Horizontal Datum: NAD 83/92 – HARN (High Accuracy Reference Network) Based**

**Ellipsoid:              WGS 84 – (World Geodetic System of 1984)**

**Vertical Datum:    NAVD 88 – (North American Vertical Datum of 1988)**

**NGS Unpublished (City of Wheat Ridge Surveyed Point)**

**Combined Factors: 0.999747803 (ground to grid)**

**1.00025226062 (grid to ground - City Datum)**

	<u>Northing</u>	<u>Easting</u>	
<b><u>SPCS:</u></b>	1710501.3190	3099111.8123	
<b><u>City Datum:</u></b>	710932.8111	99893.5961	(Millions truncated in City Datum)
<b><u>Height:</u></b>	5497.53	US Feet (Adjusted)	

No Image Available

No Image Available

This monument is located on the northerly side of Mount Olivet Cemetery in unincorporated Jefferson County, Colorado, south of the BNSF Railway line, at the intersection of W. 48th Ave. extended and Alkire St. extended.



## City of Wheat Ridge Survey Monument

**City Designation: POINT 12009**

**Monument Description:** West 1/4 Corner Section 17, T3S, R69W, of the 6th Principal Meridian.

(SPCS) State Plane Coordinate System, Colorado Central

FIPZONE: 502      ADSZONE: 3476      UTM ZONES: 12 & 13

State/County:      Colorado/Jefferson

Colorado Land Survey Master Index Number:      5-P

Horizontal Datum: NAD 83/92 – HARN (High Accuracy Reference Network) Based

Ellipsoid:      WGS 84 – (World Geodetic System of 1984)

Vertical Datum:      NAVD 88 – (North American Vertical Datum of 1988)

NGS Unpublished (City of Wheat Ridge Surveyed Point)

Combined Factors: 0.999747803 (ground to grid)

1.00025226062 (grid to ground - City Datum)

	<u>Northing</u>	<u>Easting</u>	
<u>SPCS:</u>	1713139.2498	3099084.4142	
<u>City Datum:</u>	713571.4074	99866.1912	(Millions truncated in City Datum)
<u>Height:</u>	5529.48	US Feet (Adjusted)	



The monument is located in Unincorporated Jefferson County, Colorado at the intersection of W. 52nd Ave. and Alkire St. to the North.





# City of Wheat Ridge Survey Monument

**City Designation: POINT 160002**

**Monument Description:** 1/16 Corner Section 29, T3S, R69W, of the 6th Principal Meridian.

(SPCS) State Plane Coordinate System, Colorado Central

FIPZONE: 502      ADSZONE: 3476      UTM ZONES: 12 & 13

State/County:      Colorado/Jefferson

Colorado Land Survey Master Index Number:      6-G

Horizontal Datum: NAD 83/92 – HARN (High Accuracy Reference Network) Based

Ellipsoid:      WGS 84 – (World Geodetic System of 1984)

Vertical Datum:      NAVD 88 – (North American Vertical Datum of 1988)

NGS Unpublished (City of Wheat Ridge Surveyed Point)

Combined Factors: 0.999747803 (ground to grid)

1.00025226062 (grid to ground - City Datum)

	<u>Northing</u>	<u>Easting</u>	
<u>SPCS:</u>	1702584.6015	3100493.4138	
<u>City Datum:</u>	703014.0965	101275.5461	(Millions truncated in City Datum)
<u>Height:</u>	5528.30	US Feet (Adjusted)	

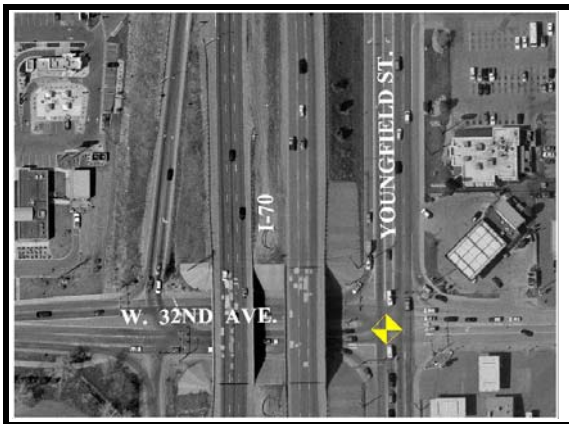

The monument is located in the City of Wheat Ridge, Colorado in the intersection of W. 32nd Ave. and Youngfield St.



## City of Wheat Ridge Survey Monument

**City Designation: POINT 160003**

**Monument Description:** 1/16 Corner Section 29, T3S, R69W, of the 6th Principal Meridian.

(SPCS) State Plane Coordinate System, Colorado Central

FIPSZONE: 502      ADSZONE: 3476      UTM ZONES: 12 & 13

State/County:      Colorado/Jefferson

Colorado Land Survey Master Index Number:      6-H

Horizontal Datum: NAD 83/92 – HARN (High Accuracy Reference Network) Based

Ellipsoid:      WGS 84 – (World Geodetic System of 1984)

Vertical Datum:      NAVD 88 – (North American Vertical Datum of 1988)

NGS Unpublished (City of Wheat Ridge Surveyed Point)

Combined Factors: 0.999747803 (ground to grid)

1.00025226062 (grid to ground - City Datum)

	<u>Northing</u>	<u>Easting</u>	
<u>SPCS:</u>	1703906.2643	3100472.6318	
<u>City Datum:</u>	704336.0927	101254.7589	(Millions truncated in City Datum)
<u>Height:</u>	5510.08	US Feet (Adjusted)	



The monument is located in the City of Wheat Ridge, Colorado in the intersection of W. 35th Ave. extended and Youngfield St.



## City of Wheat Ridge Survey Monument

**City Designation: POINT 16181**

**Monument Description:** South 1/4 Corner Section 29, T3S, R69W, of the 6th Principal Meridian.

(SPCS) State Plane Coordinate System, Colorado Central

FIPZONE: 502      ADSZONE: 3476      UTM ZONES: 12 & 13

State/County:      Colorado/Jefferson

Colorado Land Survey Master Index Number:      7-E

Horizontal Datum: NAD 83/92 – HARN (High Accuracy Reference Network) Based

Ellipsoid:      WGS 84 – (World Geodetic System of 1984)

Vertical Datum:      NAVD 88 – (North American Vertical Datum of 1988)

NGS Unpublished (City of Wheat Ridge Surveyed Point)

Combined Factors: 0.999747803 (ground to grid)

1.00025226062 (grid to ground - City Datum)

	<u>Northing</u>	<u>Easting</u>	
<u>SPCS:</u>	1699948.8125	3101850.4270	
<u>City Datum:</u>	700377.6426	102632.9017	(Millions truncated in City Datum)
<u>Height:</u>	5538.43	US Feet (Adjusted)	

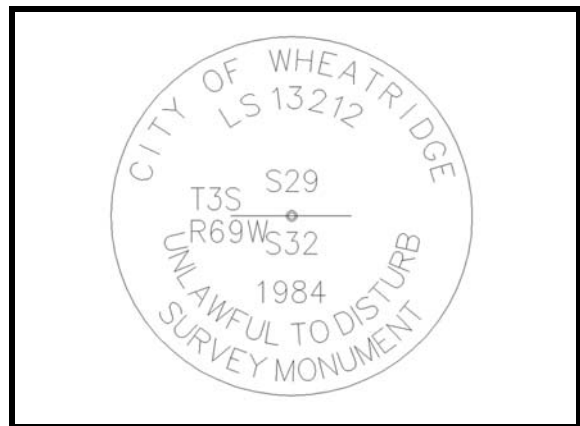

The monument is located in the City of Lakewood, Colorado in the intersection of the westerly extension of W. 26th Ave. and the extension of Ward Rd.



## City of Wheat Ridge Survey Monument

**City Designation: POINT 16109**

**Monument Description:** Center 1/4 Corner Section 29, T3S, R69W, of the 6th Principal Meridian.

(SPCS) State Plane Coordinate System, Colorado Central

FIPZONE: 502      ADSZONE: 3476      UTM ZONES: 12 & 13

State/County:      Colorado/Jefferson

Colorado Land Survey Master Index Number:      7-G

Horizontal Datum: NAD 83/92 – HARN (High Accuracy Reference Network) Based

Ellipsoid:      WGS 84 – (World Geodetic System of 1984)

Vertical Datum:      NAVD 88 – (North American Vertical Datum of 1988)

NGS Unpublished (City of Wheat Ridge Surveyed Point)

Combined Factors: 0.999747803 (ground to grid)

1.00025226062 (grid to ground - City Datum)

	<u>Northing</u>	<u>Easting</u>	
<u>SPCS:</u>	1702596.4418	3101815.5365	
<u>City Datum:</u>	703025.9398	102598.0024	(Millions truncated in City Datum)
<u>Height:</u>	5466.30	US Feet (Adjusted)	

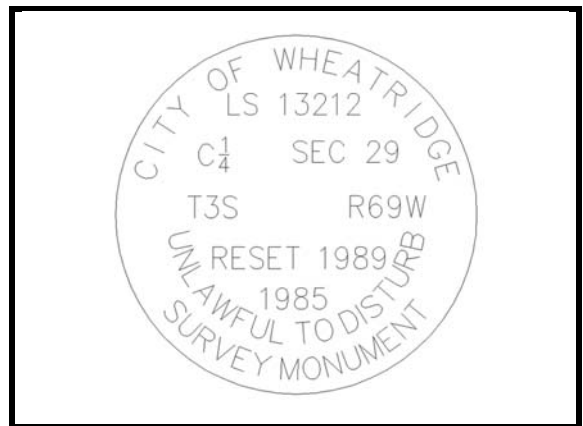

The monument is located in the City of Wheat Ridge, Colorado in the intersection of W. 32nd Ave. and Ward Rd.



## City of Wheat Ridge Survey Monument

**City Designation: POINT 15109**

**Monument Description:** South 1/4 Corner Section 20, T3S, R69W, of the 6th Principal Meridian.

(SPCS) State Plane Coordinate System, Colorado Central

FIPSZONE: 502      ADSZONE: 3476      UTM ZONES: 12 & 13

State/County:      Colorado/Jefferson

Colorado Land Survey Master Index Number:      7-J

Horizontal Datum: NAD 83/92 – HARN (High Accuracy Reference Network) Based

Ellipsoid:      WGS 84 – (World Geodetic System of 1984)

Vertical Datum:      NAVD 88 – (North American Vertical Datum of 1988)

NGS Unpublished (City of Wheat Ridge Surveyed Point)

Combined Factors: 0.999747803 (ground to grid)

1.00025226062 (grid to ground - City Datum)

	<u>Northing</u>	<u>Easting</u>	
<u>SPCS:</u>	1705242.3473	3101780.4144	
<u>City Datum:</u>	705672.5128	102562.8715	(Millions truncated in City Datum)
<u>Height:</u>	5489.84	US Feet (Adjusted)	

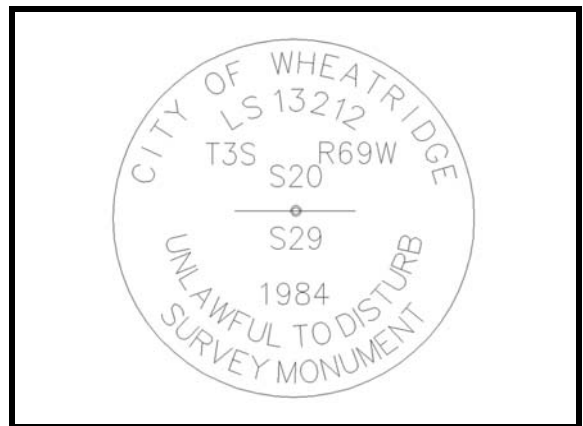

The monument is located in the City of Wheat Ridge, Colorado at the intersection of the westerly extension of W. 38th Ave and the northerly extension of Ward Rd.





## City of Wheat Ridge Survey Monument

**City Designation: POINT 14109**

**Monument Description:** Center 1/4 Corner Section 20, T3S, R69W, of the 6th Principal Meridian.

(SPCS) State Plane Coordinate System, Colorado Central

FIPSZONE: 502      ADSZONE: 3476      UTM ZONES: 12 & 13

State/County:      Colorado/Jefferson

Colorado Land Survey Master Index Number:      7-L

Horizontal Datum: NAD 83/92 – HARN (High Accuracy Reference Network) Based

Ellipsoid:      WGS 84 – (World Geodetic System of 1984)

Vertical Datum:      NAVD 88 – (North American Vertical Datum of 1988)

NGS Unpublished (City of Wheat Ridge Surveyed Point)

Combined Factors: 0.999747803 (ground to grid)

1.00025226062 (grid to ground - City Datum)

	<u>Northing</u>	<u>Easting</u>	
<u>SPCS:</u>	1707895.9138	3101768.8045	
<u>City Datum:</u>	708326.7486	102551.2586	(Millions truncated in City Datum)
<u>Height:</u>	5431.35	US Feet (Adjusted)	

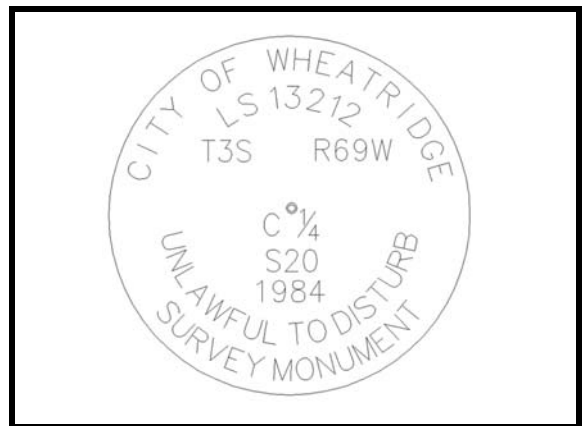

The monument is located in the City of Wheat Ridge, Colorado at the intersection of W. 44th Ave. extended west and Ward Rd. extended southerly.



## City of Wheat Ridge Survey Monument

**City Designation: POINT 13109**

**Monument Description:** South 1/4 Corner Section 17, T3S, R69W, of the 6th Principal Meridian.

(SPCS) State Plane Coordinate System, Colorado Central

FIPSZONE: 502      ADSZONE: 3476      UTM ZONES: 12 & 13

State/County:      Colorado/Jefferson

Colorado Land Survey Master Index Number:      7-N

Horizontal Datum: NAD 83/92 – HARN (High Accuracy Reference Network) Based

Ellipsoid:      WGS 84 – (World Geodetic System of 1984)

Vertical Datum:      NAVD 88 – (North American Vertical Datum of 1988)

NGS Unpublished (City of Wheat Ridge Surveyed Point)

Combined Factors: 0.999747803 (ground to grid)

1.00025226062 (grid to ground - City Datum)

	<u>Northing</u>	<u>Easting</u>	
<u>SPCS:</u>	1710537.5325	3101757.2008	
<u>City Datum:</u>	710969.0338	102539.6519	(Millions truncated in City Datum)
<u>Height:</u>	5468.69	US Feet (Adjusted)	

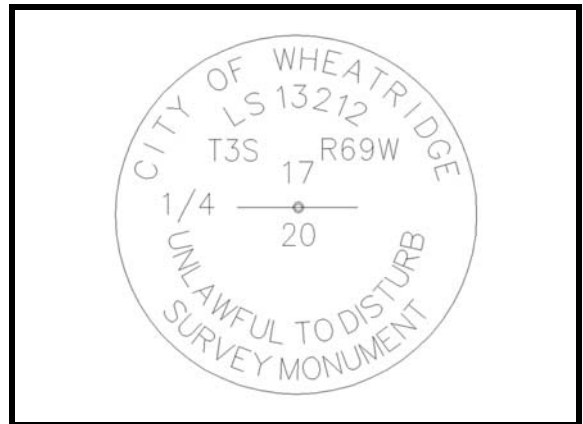

The monument is located in the City of Wheat Ridge, Colorado at the intersection of W. 48th Ave. and Ward Road.



## City of Wheat Ridge Survey Monument

**City Designation: POINT 12109**

**Monument Description:** Center 1/4 Corner Section 17, T3S, R69W, of the 6th Principal Meridian.

(SPCS) State Plane Coordinate System, Colorado Central

FIPZONE: 502      ADSZONE: 3476      UTM ZONES: 12 & 13

State/County:      Colorado/Jefferson

Colorado Land Survey Master Index Number:      7-P

Horizontal Datum: NAD 83/92 – HARN (High Accuracy Reference Network) Based

Ellipsoid:      WGS 84 – (World Geodetic System of 1984)

Vertical Datum:      NAVD 88 – (North American Vertical Datum of 1988)

NGS Unpublished (City of Wheat Ridge Surveyed Point)

Combined Factors: 0.999747803 (ground to grid)

1.00025226062 (grid to ground - City Datum)

	<u>Northing</u>	<u>Easting</u>	
<u>SPCS:</u>	1713176.7555	3101742.8843	
<u>City Datum:</u>	713608.9225	102525.3318	(Millions truncated in City Datum)
<u>Height:</u>	5504.93	US Feet (Adjusted)	

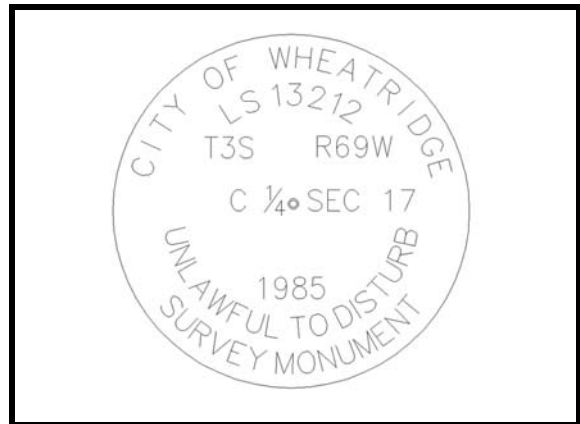

The monument is located in the City of Wheat Ridge, Colorado in the intersection of W. 52nd Ave. & Ward Rd.



## City of Wheat Ridge Survey Monument

**City Designation: POINT 160004**

**Monument Description:** 1/16 Corner Section 29, T3S, R69W, of the 6th Principal Meridian.

(SPCS) State Plane Coordinate System, Colorado Central

FIPZONE: 502      ADSZONE: 3476      UTM ZONES: 12 & 13

State/County:      Colorado/Jefferson

Colorado Land Survey Master Index Number:      8-G

Horizontal Datum: NAD 83/92 – HARN (High Accuracy Reference Network) Based

Ellipsoid:      WGS 84 – (World Geodetic System of 1984)

Vertical Datum:      NAVD 88 – (North American Vertical Datum of 1988)

NGS Unpublished (City of Wheat Ridge Surveyed Point)

Combined Factors: 0.999747803 (ground to grid)

1.00025226062 (grid to ground - City Datum)

	<u>Northing</u>	<u>Easting</u>	
<u>SPCS:</u>	1702608.2418	3103146.5673	
<u>City Datum:</u>	703037.7428	103929.3689	(Millions truncated in City Datum)
<u>Height:</u>	5474.20	US Feet (Adjusted)	

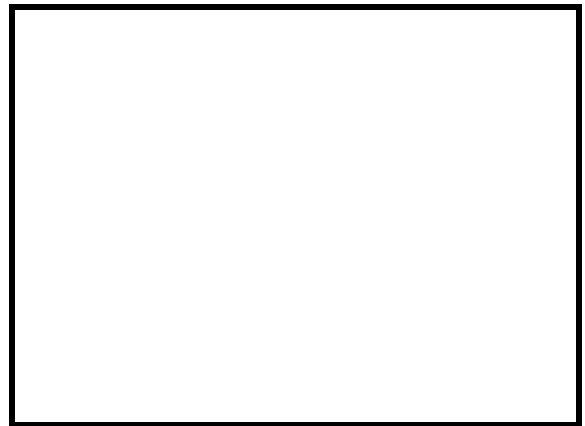

The monument is located in the City of Wheat Ridge, Colorado in the intersection of W. 32nd Ave. and Union St.



## City of Wheat Ridge Survey Monument

**City Designation: POINT 16281**

**Monument Description:** Southeast 1/4 Corner Section 29, T3S, R69W, of the 6th Principal Meridian.

(SPCS) State Plane Coordinate System, Colorado Central

FIPZONE: 502      ADSZONE: 3476      UTM ZONES: 12 & 13

State/County:      Colorado/Jefferson

Colorado Land Survey Master Index Number:      9-E

Horizontal Datum: NAD 83/92 – HARN (High Accuracy Reference Network) Based

Ellipsoid:      WGS 84 – (World Geodetic System of 1984)

Vertical Datum:      NAVD 88 – (North American Vertical Datum of 1988)

NGS Unpublished (City of Wheat Ridge Surveyed Point)

Combined Factors: 0.999747803 (ground to grid)

1.00025226062 (grid to ground - City Datum)

	<u>Northing</u>	<u>Easting</u>	
<u>SPCS:</u>	1699968.5543	3104487.9593	
<u>City Datum:</u>	700397.3894	105271.0993	(Millions truncated in City Datum)
<u>Height:</u>	5563.42	US Feet (Adjusted)	

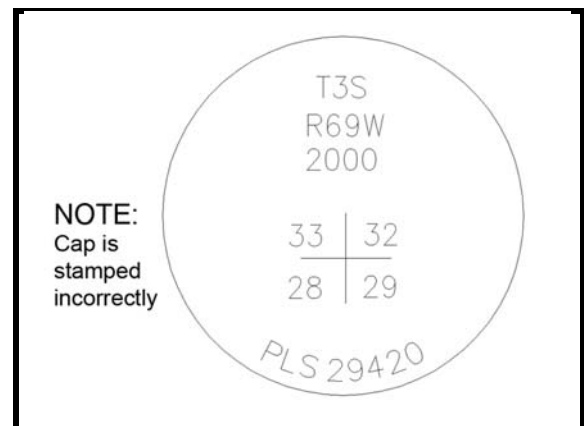

The monument is located in the City of Lakewood, Colorado in the intersection of W. 26th Ave. and Simms St.





## City of Wheat Ridge Survey Monument

**City Designation: POINT 16209**

**Monument Description:** East 1/4 Corner Section 29, T3S, R69W, of the 6th Principal Meridian.

(SPCS) State Plane Coordinate System, Colorado Central

FIPSZONE: 502      ADSZONE: 3476      UTM ZONES: 12 & 13

State/County:      Colorado/Jefferson

Colorado Land Survey Master Index Number:      9-G

Horizontal Datum: NAD 83/92 – HARN (High Accuracy Reference Network) Based

Ellipsoid:      WGS 84 – (World Geodetic System of 1984)

Vertical Datum:      NAVD 88 – (North American Vertical Datum of 1988)

NGS Unpublished (City of Wheat Ridge Surveyed Point)

Combined Factors: 0.999747803 (ground to grid)

1.00025226062 (grid to ground - City Datum)

	<u>Northing</u>	<u>Easting</u>	
<u>SPCS:</u>	1702620.0523	3104477.5803	
<u>City Datum:</u>	703049.5562	105260.7177	(Millions truncated in City Datum)
<u>Height:</u>	5454.70	US Feet (Adjusted)	

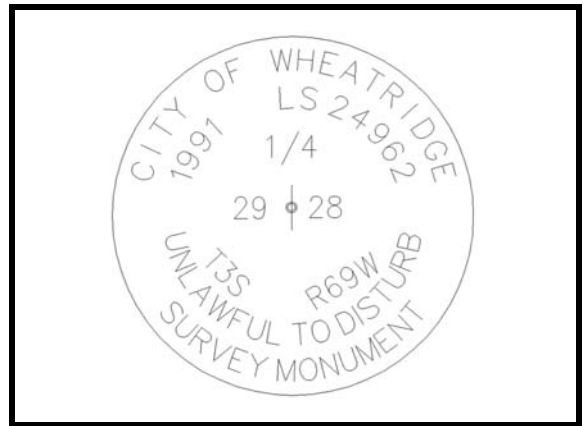

The monument is located in the City of Wheat Ridge, Colorado in the intersection of W. 32nd Ave. and Simms St.



## City of Wheat Ridge Survey Monument

**City Designation: POINT 15209**

**Monument Description:** Northeast 1/4 Corner Section 29, T3S, R69W, of the 6th Principal Meridian.

(SPCS) State Plane Coordinate System, Colorado Central

FIPZONE: 502      ADSZONE: 3476      UTM ZONES: 12 & 13

State/County:      Colorado/Jefferson

Colorado Land Survey Master Index Number:      9-J

Horizontal Datum: NAD 83/92 – HARN (High Accuracy Reference Network) Based

Ellipsoid:      WGS 84 – (World Geodetic System of 1984)

Vertical Datum:      NAVD 88 – (North American Vertical Datum of 1988)

NGS Unpublished (City of Wheat Ridge Surveyed Point)

Combined Factors: 0.999747803 (ground to grid)

1.00025226062 (grid to ground - City Datum)

	<u>Northing</u>	<u>Easting</u>	
<u>SPCS:</u>	1705271.3730	3104447.0378	
<u>City Datum:</u>	705701.5458	105230.1675	(Millions truncated in City Datum)
<u>Height:</u>	5456.90	US Feet (Adjusted)	

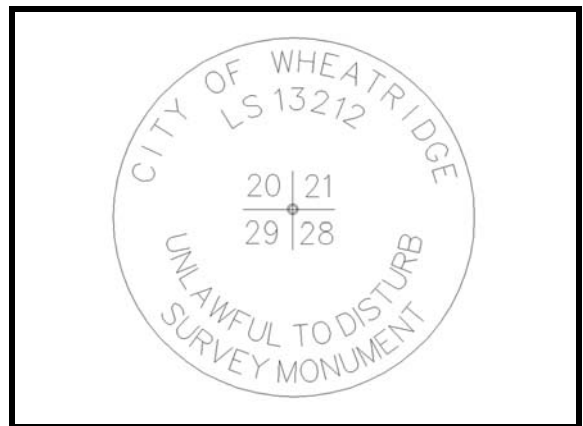

The monument is located in the City of Wheat Ridge, Colorado at the intersection of W. 38th Ave. and Simms St. extended.



## City of Wheat Ridge Survey Monument

**City Designation: POINT 14209**

**Monument Description:** East 1/4 Corner Section 20, T3S, R69W, of the 6th Principal Meridian.

(SPCS) State Plane Coordinate System, Colorado Central

FIPSZONE: 502    ADSZONE: 3476    UTM ZONES: 12 & 13

State/County:    Colorado/Jefferson

Colorado Land Survey Master Index Number:    9-L

Horizontal Datum: NAD 83/92 – HARN (High Accuracy Reference Network) Based

Ellipsoid:    WGS 84 – (World Geodetic System of 1984)

Vertical Datum:    NAVD 88 – (North American Vertical Datum of 1988)

NGS Unpublished (City of Wheat Ridge Surveyed Point)

Combined Factors: 0.999747803 (ground to grid)

1.00025226062 (grid to ground - City Datum)

	<u>Northing</u>	<u>Easting</u>	
<u>SPCS:</u>	1707935.1331	3104427.7611	
<u>City Datum:</u>	708365.9779	105210.8860	(Millions truncated in City Datum)
<u>Height:</u>	5409.09	US Feet (Adjusted)	

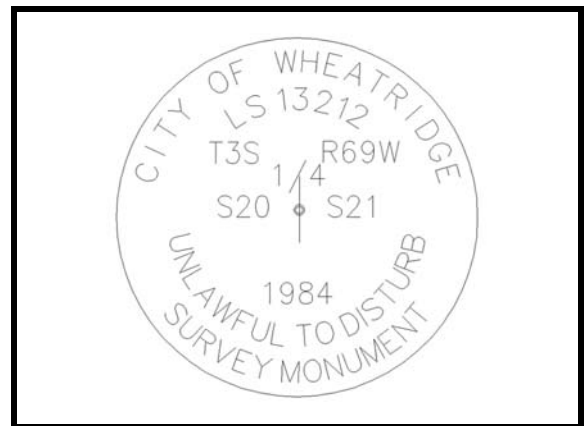

The monument is located in the City of Wheat Ridge, Colorado at the intersection of W. 44th Ave. extended westerly and Simms St. extended northerly.



## City of Wheat Ridge Survey Monument

**City Designation: POINT 13209**

**Monument Description:** Northeast 1/4 Corner Section 20, T3S, R69W, of the 6th Principal Meridian.

(SPCS) State Plane Coordinate System, Colorado Central

FIPSZONE: 502      ADSZONE: 3476      UTM ZONES: 12 & 13

State/County:      Colorado/Jefferson

Colorado Land Survey Master Index Number:      9-N

Horizontal Datum: NAD 83/92 – HARN (High Accuracy Reference Network) Based

Ellipsoid:      WGS 84 – (World Geodetic System of 1984)

Vertical Datum:      NAVD 88 – (North American Vertical Datum of 1988)

NGS Unpublished (City of Wheat Ridge Surveyed Point)

Combined Factors: 0.999747803 (ground to grid)

1.00025226062 (grid to ground - City Datum)

	<u>Northing</u>	<u>Easting</u>	
<u>SPCS:</u>	1710573.3255	3104403.6097	
<u>City Datum:</u>	711004.8358	105186.7285	(Millions truncated in City Datum)
<u>Height:</u>	5400.31	US Feet (Adjusted)	

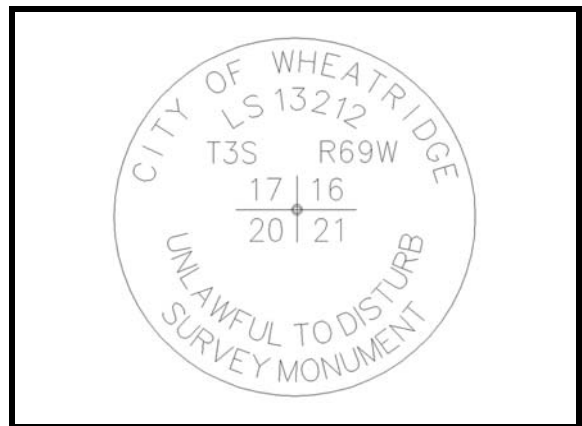
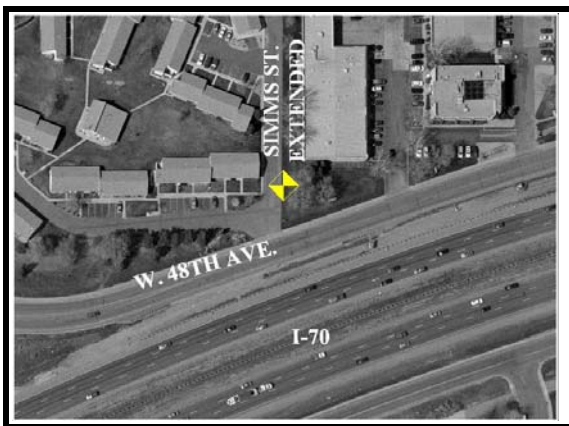

The monument is located in the City of Wheat Ridge, Colorado. To reach the monument, travel to the intersection of W. 48th Avenue (North 1-70 Frontage Road) & Tabor St. Travel eastward on W. 48th Ave to Simms St. extended, and turn north into the parking lot located there. The monument is approx. 100' north of W. 48th Ave.



## City of Wheat Ridge Survey Monument

**City Designation: POINT 12209**

**Monument Description:** East 1/4 Corner Section 17, T3S, R69W, of the 6th Principal Meridian.

(SPCS) State Plane Coordinate System, Colorado Central

FIPSZONE: 502      ADSZONE: 3476      UTM ZONES: 12 & 13

State/County:      Colorado/Jefferson

Colorado Land Survey Master Index Number:      9-P

Horizontal Datum: NAD 83/92 – HARN (High Accuracy Reference Network) Based

Ellipsoid:      WGS 84 – (World Geodetic System of 1984)

Vertical Datum:      NAVD 88 – (North American Vertical Datum of 1988)

NGS Unpublished (City of Wheat Ridge Surveyed Point)

Combined Factors: 0.999747803 (ground to grid)

1.00025226062 (grid to ground - City Datum)

	<u>Northing</u>	<u>Easting</u>	
<u>SPCS:</u>	1713214.3018	3104388.8933	
<u>City Datum:</u>	713646.4783	105172.0083	(Millions truncated in City Datum)
<u>Height:</u>	5465.28	US Feet (Adjusted)	

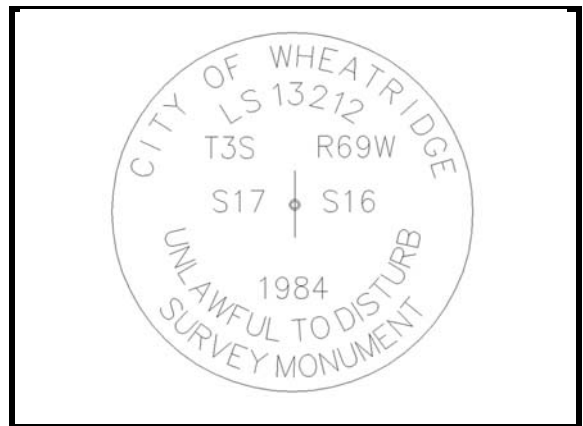
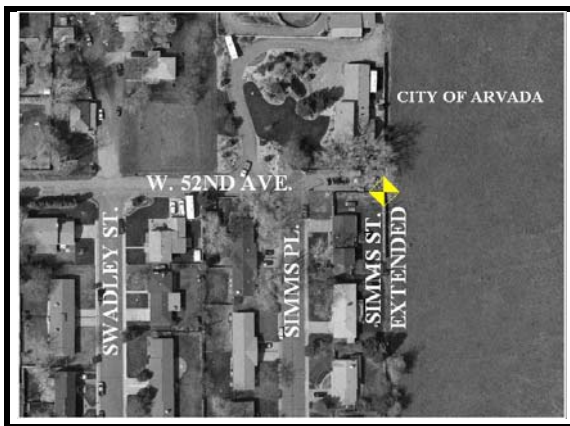

The monument is located in the City of Wheat Ridge, Colorado. To reach the monument, travel to the intersection of 52nd Avenue & Simms Pl. Travel eastward on W. 52nd Ave. to its termination. The monument is located at approximately the southeast corner of the ROW.





## City of Wheat Ridge Survey Monument

**City Designation: POINT 16381**

**Monument Description:** South 1/4 Corner Section 28, T3S, R69W, of the 6th Principal Meridian.

(SPCS) State Plane Coordinate System, Colorado Central

FIPZONE: 502      ADSZONE: 3476      UTM ZONES: 12 & 13

State/County:      Colorado/Jefferson

Colorado Land Survey Master Index Number:      11-E

Horizontal Datum: NAD 83/92 – HARN (High Accuracy Reference Network) Based

Ellipsoid:      WGS 84 – (World Geodetic System of 1984)

Vertical Datum:      NAVD 88 – (North American Vertical Datum of 1988)

NGS Unpublished (City of Wheat Ridge Surveyed Point)

Combined Factors: 0.999747803 (ground to grid)

1.00025226062 (grid to ground - City Datum)

	<u>Northing</u>	<u>Easting</u>	
<u>SPCS:</u>	1699994.2263	3107115.1555	
<u>City Datum:</u>	700423.0678	107898.9583	(Millions truncated in City Datum)
<u>Height:</u>	5580.26	US Feet (Adjusted)	



The monument is located in the City of Wheat Ridge, Colorado in the intersection of W. 26th Ave. and Oak St.





## City of Wheat Ridge Survey Monument

**City Designation: POINT 16309**

**Monument Description:** Center 1/4 Corner Section 28, T3S, R69W, of the 6th Principal Meridian.

**(SPCS) State Plane Coordinate System, Colorado Central**

**FIPSZONE: 502      ADSZONE: 3476      UTM ZONES: 12 & 13**

**State/County:      Colorado/Jefferson**

**Colorado Land Survey Master Index Number:      11-G**

**Horizontal Datum: NAD 83/92 – HARN (High Accuracy Reference Network) Based**

**Ellipsoid:      WGS 84 – (World Geodetic System of 1984)**

**Vertical Datum:      NAVD 88 – (North American Vertical Datum of 1988)**

**NGS Unpublished (City of Wheat Ridge Surveyed Point)**

**Combined Factors: 0.999747803 (ground to grid)**

**1.00025226062 (grid to ground - City Datum)**

	<u>Northing</u>	<u>Easting</u>	
<b><u>SPCS:</u></b>	1702650.6595	3107100.3796	
<b><u>City Datum:</u></b>	703080.1713	107884.1787	(Millions truncated in City Datum)
<b><u>Height:</u></b>	5461.94	US Feet (Adjusted)	

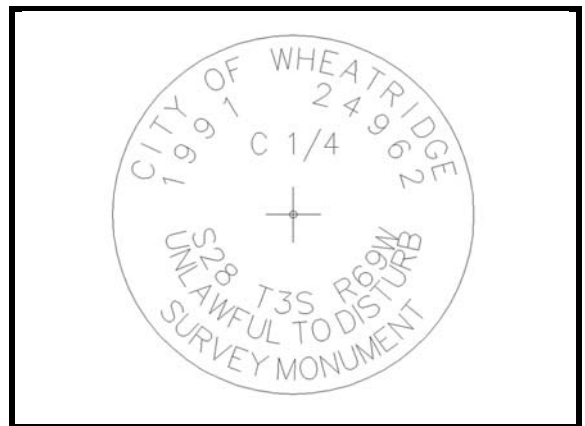

**The monument is located in the City of Wheat Ridge, Colorado in the intersection of W. 32nd Ave. and Oak St.**



## City of Wheat Ridge Survey Monument

**City Designation: POINT 15309**

**Monument Description:** South 1/4 Corner Section 21, T3S, R69W, of the 6th Principal Meridian.

(SPCS) State Plane Coordinate System, Colorado Central

FIPZONE: 502      ADSZONE: 3476      UTM ZONES: 12 & 13

State/County:      Colorado/Jefferson

Colorado Land Survey Master Index Number:      11-J

Horizontal Datum: NAD 83/92 – HARN (High Accuracy Reference Network) Based

Ellipsoid:      WGS 84 – (World Geodetic System of 1984)

Vertical Datum:      NAVD 88 – (North American Vertical Datum of 1988)

NGS Unpublished (City of Wheat Ridge Surveyed Point)

Combined Factors: 0.999747803 (ground to grid)

1.00025226062 (grid to ground - City Datum)

	<u>Northing</u>	<u>Easting</u>	
<u>SPCS:</u>	1705307.2948	3107085.8513	
<u>City Datum:</u>	705737.4766	107869.6467	(Millions truncated in City Datum)
<u>Height:</u>	5402.08	US Feet (Adjusted)	



The monument is located in the City of Wheat Ridge, Colorado in the intersection of W. 38th Ave. and Oak St.



## City of Wheat Ridge Survey Monument

**City Designation: POINT 14309**

**Monument Description:** Center 1/4 Corner Section 21, T3S, R69W, of the 6th Principal Meridian.

(SPCS) State Plane Coordinate System, Colorado Central

FIPZONE: 502      ADSZONE: 3476      UTM ZONES: 12 & 13

State/County:      Colorado/Jefferson

Colorado Land Survey Master Index Number:      11-L

Horizontal Datum: NAD 83/92 – HARN (High Accuracy Reference Network) Based

Ellipsoid:      WGS 84 – (World Geodetic System of 1984)

Vertical Datum:      NAVD 88 – (North American Vertical Datum of 1988)

NGS Unpublished (City of Wheat Ridge Surveyed Point)

Combined Factors: 0.999747803 (ground to grid)

1.00025226062 (grid to ground - City Datum)

	<u>Northing</u>	<u>Easting</u>	
<u>SPCS:</u>	1707954.0600	3107071.5600	
<u>City Datum:</u>	708384.9096	107855.3518	(Millions truncated in City Datum)
<u>Height:</u>	5386.00	US Feet (Adjusted)	

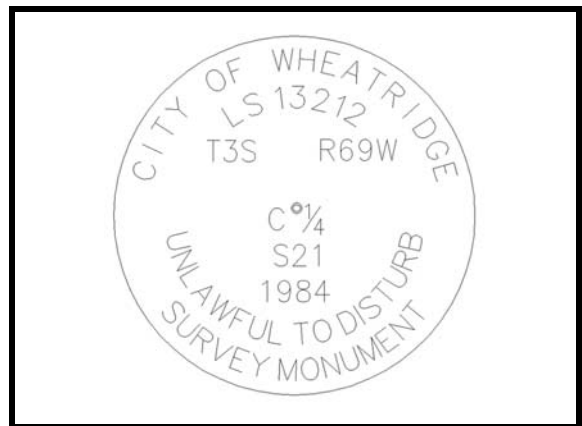

The monument is located in the City of Wheat Ridge, Colorado on the westerly extension of W. 44th Ave. between Oak St. and Owens St.



## City of Wheat Ridge Survey Monument

**City Designation: POINT 13309**

**Monument Description:** South 1/4 Corner Section 16, T3S, R69W, of the 6th Principal Meridian.

(SPCS) State Plane Coordinate System, Colorado Central

FIPZONE: 502      ADSZONE: 3476      UTM ZONES: 12 & 13

State/County:      Colorado/Jefferson

Colorado Land Survey Master Index Number:      11-N

Horizontal Datum: NAD 83/92 – HARN (High Accuracy Reference Network) Based

Ellipsoid:      WGS 84 – (World Geodetic System of 1984)

Vertical Datum:      NAVD 88 – (North American Vertical Datum of 1988)

NGS Unpublished (City of Wheat Ridge Surveyed Point)

Combined Factors: 0.999747803 (ground to grid)

1.00025226062 (grid to ground - City Datum)

	<u>Northing</u>	<u>Easting</u>	
<u>SPCS:</u>	1710599.2470	3107057.2848	
<u>City Datum:</u>	711030.7638	107841.0729	(Millions truncated in City Datum)
<u>Height:</u>	5383.92	US Feet (Adjusted)	

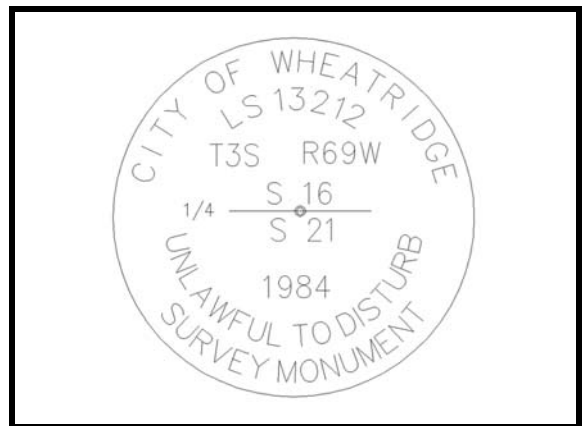

The monument is located in the City of Wheat Ridge, Colorado near the W. I-70 Frontage Road South at the northerly extension of Oak Street.



## City of Wheat Ridge Survey Monument

**City Designation: POINT 12309**

**Monument Description:** Center 1/4 Corner Section 16, T3S, R69W, of the 6th Principal Meridian.

(SPCS) State Plane Coordinate System, Colorado Central

FIPSZONE: 502      ADSZONE: 3476      UTM ZONES: 12 & 13

State/County:      Colorado/Jefferson

Colorado Land Survey Master Index Number:      11-P

Horizontal Datum: NAD 83/92 – HARN (High Accuracy Reference Network) Based

Ellipsoid:      WGS 84 – (World Geodetic System of 1984)

Vertical Datum:      NAVD 88 – (North American Vertical Datum of 1988)

NGS Unpublished (City of Wheat Ridge Surveyed Point)

Combined Factors: 0.999747803 (ground to grid)

1.00025226062 (grid to ground - City Datum)

	<u>Northing</u>	<u>Easting</u>	
<u>SPCS:</u>	1713235.2636	3107047.1862	
<u>City Datum:</u>	713667.4454	107830.9718	(Millions truncated in City Datum)
<u>Height:</u>	5438.00	US Feet (Adjusted)	

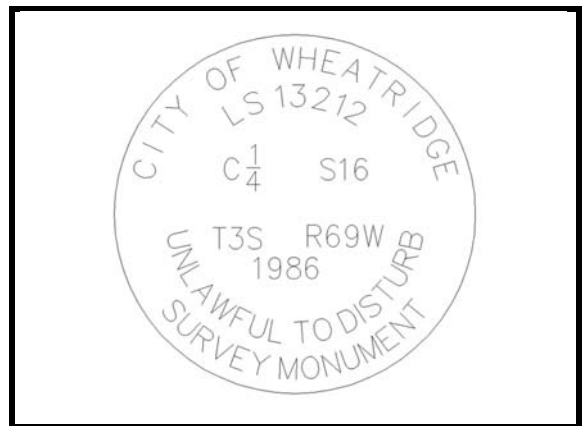

The monument is located in the City of Wheat Ridge, Colorado. To reach the monument, travel to the intersection of Oak Street extended and Ridge Road.





## City of Wheat Ridge Survey Monument

**City Designation: POINT 16481**

**Monument Description:** Southeast 1/4 Corner Section 28, T3S, R69W, of the 6th Principal Meridian.

(SPCS) State Plane Coordinate System, Colorado Central

FIPSZONE: 502      ADSZONE: 3476      UTM ZONES: 12 & 13

State/County:      Colorado/Jefferson

Colorado Land Survey Master Index Number:      13-E

Horizontal Datum: NAD 83/92 – HARN (High Accuracy Reference Network) Based

Ellipsoid:      WGS 84 – (World Geodetic System of 1984)

Vertical Datum:      NAVD 88 – (North American Vertical Datum of 1988)

NGS Unpublished (City of Wheat Ridge Surveyed Point)

Combined Factors: 0.999747803 (ground to grid)

1.00025226062 (grid to ground - City Datum)

	<u>Northing</u>	<u>Easting</u>	
<u>SPCS:</u>	1700019.8803		
<u>City Datum:</u>	700448.7283	110546.9069	(Millions truncated in City Datum)
<u>Height:</u>	5574.77	US Feet (Adjusted)	

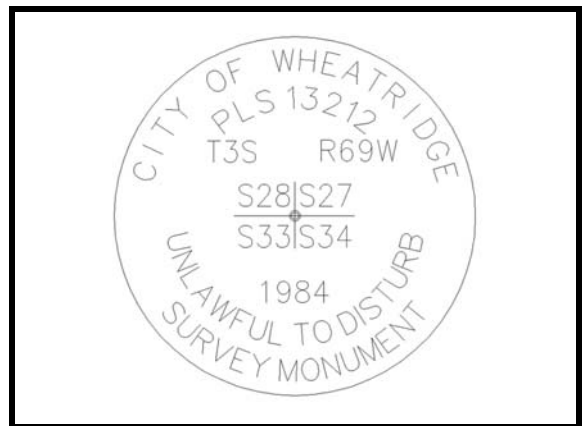

The monument is located in the City of Wheat Ridge, Colorado in the intersection of W. 26th Ave. and Kipling St.





## City of Wheat Ridge Survey Monument

**City Designation: POINT 16409**

**Monument Description:** East 1/4 Corner Section 28, T3S, R69W, of the 6th Principal Meridian.

(SPCS) State Plane Coordinate System, Colorado Central

FIPZONE: 502      ADSZONE: 3476      UTM ZONES: 12 & 13

State/County:      Colorado/Jefferson

Colorado Land Survey Master Index Number:      13-G

Horizontal Datum: NAD 83/92 – HARN (High Accuracy Reference Network) Based

Ellipsoid:      WGS 84 – (World Geodetic System of 1984)

Vertical Datum:      NAVD 88 – (North American Vertical Datum of 1988)

NGS Unpublished (City of Wheat Ridge Surveyed Point)

Combined Factors: 0.999747803 (ground to grid)

1.00025226062 (grid to ground - City Datum)

	<u>Northing</u>	<u>Easting</u>	
<u>SPCS:</u>	1702681.0581	3109736.7826	
<u>City Datum:</u>	703110.5775	110521.2468	(Millions truncated in City Datum)
<u>Height:</u>	5562.96	US Feet (Adjusted)	

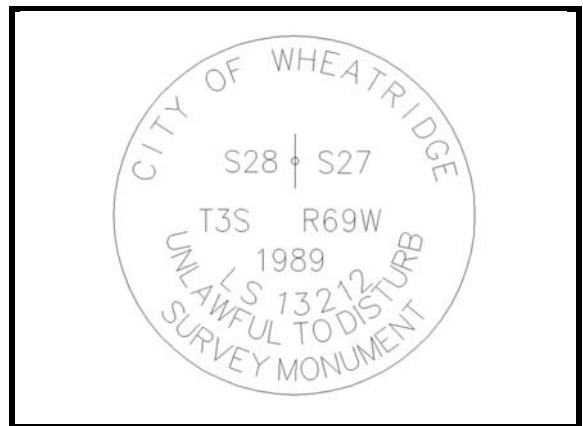

The monument is located in the City of Wheat Ridge, Colorado in the intersection of W. 32nd Ave. and Kipling St.



# City of Wheat Ridge Survey Monument

**City Designation: POINT 160005**

**Monument Description:** 1/16 Corner Section 28, T3S, R69W, of the 6th Principal Meridian.

(SPCS) State Plane Coordinate System, Colorado Central

FIPZONE: 502      ADSZONE: 3476      UTM ZONES: 12 & 13

State/County:      Colorado/Jefferson

Colorado Land Survey Master Index Number:      13-H

Horizontal Datum: NAD 83/92 – HARN (High Accuracy Reference Network) Based

Ellipsoid:      WGS 84 – (World Geodetic System of 1984)

Vertical Datum:      NAVD 88 – (North American Vertical Datum of 1988)

NGS Unpublished (City of Wheat Ridge Surveyed Point)

Combined Factors: 0.999747803 (ground to grid)

1.00025226062 (grid to ground - City Datum)

	<u>Northing</u>	<u>Easting</u>	
<u>SPCS:</u>	1704012.3279	3109731.8855	
<u>City Datum:</u>	704442.1831	110516.3484	(Millions truncated in City Datum)
<u>Height:</u>	5461.77	US Feet (Adjusted)	

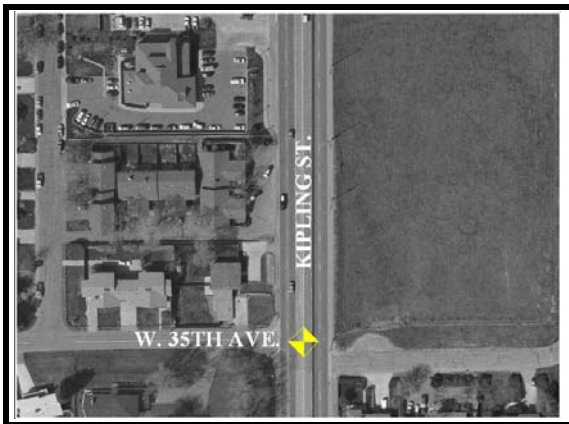

The monument is located in the City of Wheat Ridge, Colorado in the intersection of W. 35th Ave. and Kipling St.



## City of Wheat Ridge Survey Monument

**City Designation: POINT 15409**

**Monument Description:** Northeast 1/4 Corner Section 28, T3S, R69W, of the 6th Principal Meridian.

(SPCS) State Plane Coordinate System, Colorado Central

FIPSZONE: 502      ADSZONE: 3476      UTM ZONES: 12 & 13

State/County:      Colorado/Jefferson

Colorado Land Survey Master Index Number:      13-J

Horizontal Datum: NAD 83/92 – HARN (High Accuracy Reference Network) Based

Ellipsoid:      WGS 84 – (World Geodetic System of 1984)

Vertical Datum:      NAVD 88 – (North American Vertical Datum of 1988)

NGS Unpublished (City of Wheat Ridge Surveyed Point)

Combined Factors: 0.999747803 (ground to grid)

1.00025226062 (grid to ground - City Datum)

	<u>Northing</u>	<u>Easting</u>	
<u>SPCS:</u>	1705343.5428	3109727.0032	
<u>City Datum:</u>	705773.7338	110511.4649	(Millions truncated in City Datum)
<u>Height:</u>	5396.45	US Feet (Adjusted)	



The monument is located in the City of Wheat Ridge, Colorado in the intersection of W. 38th Ave. and Kipling St.



# City of Wheat Ridge Survey Monument

**City Designation: POINT 160006**

**Monument Description:** South 1/16 Corner Section 28, T3S, R69W, of the 6th Principal Meridian.

(SPCS) State Plane Coordinate System, Colorado Central

FIPSZONE: 502      ADSZONE: 3476      UTM ZONES: 12 & 13

State/County:      Colorado/Jefferson

Colorado Land Survey Master Index Number:      13-K

Horizontal Datum: NAD 83/92 – HARN (High Accuracy Reference Network) Based

Ellipsoid:      WGS 84 – (World Geodetic System of 1984)

Vertical Datum:      NAVD 88 – (North American Vertical Datum of 1988)

NGS Unpublished (City of Wheat Ridge Surveyed Point)

Combined Factors: 0.999747803 (ground to grid)

1.00025226062 (grid to ground - City Datum)

	<u>Northing</u>	<u>Easting</u>	
<u>SPCS:</u>	1706658.3220	3109725.1428	
<u>City Datum:</u>	707088.8447	110509.6039	(Millions truncated in City Datum)
<u>Height:</u>	5365.26	US Feet (Adjusted)	

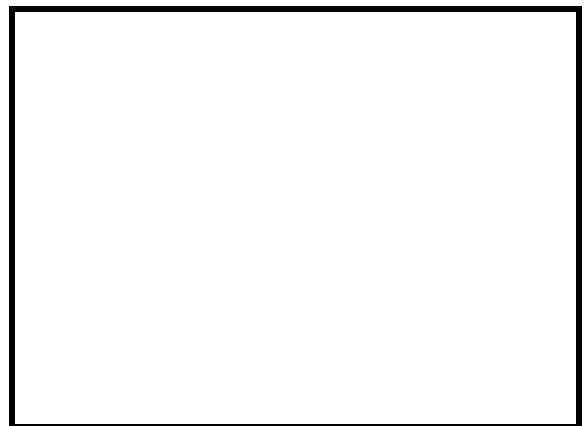

The monument is located in the City of Wheat Ridge, Colorado south of the intersection of W. 41st Ave. and Kipling St.



## City of Wheat Ridge Survey Monument

**City Designation: POINT 14409**

**Monument Description:** East 1/4 Corner Section 21, T3S, R69W, of the 6th Principal Meridian.

(SPCS) State Plane Coordinate System, Colorado Central

FIPZONE: 502      ADSZONE: 3476      UTM ZONES: 12 & 13

State/County:      Colorado/Jefferson

Colorado Land Survey Master Index Number:      13-L

Horizontal Datum: NAD 83/92 – HARN (High Accuracy Reference Network) Based

Ellipsoid:      WGS 84 – (World Geodetic System of 1984)

Vertical Datum:      NAVD 88 – (North American Vertical Datum of 1988)

NGS Unpublished (City of Wheat Ridge Surveyed Point)

Combined Factors: 0.999747803 (ground to grid)

1.00025226062 (grid to ground - City Datum)

	<u>Northing</u>	<u>Easting</u>	
<u>SPCS:</u>	1707973.1728	3109723.2409	
<u>City Datum:</u>	708404.0271	110507.7016	(Millions truncated in City Datum)
<u>Height:</u>	5368.01	US Feet (Adjusted)	

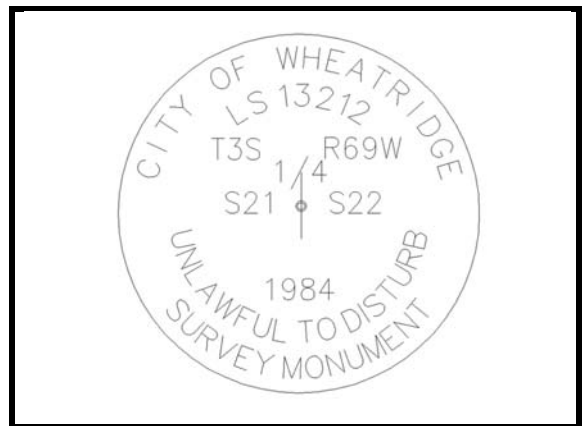

The monument is located in the City of Wheat Ridge, Colorado at the intersection of W. 43rd Ave. (westerly extension of W. 44th Ave.) and Kipling St.



## City of Wheat Ridge Survey Monument

**City Designation: POINT 13409**

**Monument Description:** Northeast 1/4 Corner Section 21, T3S, R69W, of the 6th Principal Meridian.

(SPCS) State Plane Coordinate System, Colorado Central

FIPZONE: 502      ADSZONE: 3476      UTM ZONES: 12 & 13

State/County:      Colorado/Jefferson

Colorado Land Survey Master Index Number:      13-N

Horizontal Datum: NAD 83/92 – HARN (High Accuracy Reference Network) Based

Ellipsoid:      WGS 84 – (World Geodetic System of 1984)

Vertical Datum:      NAVD 88 – (North American Vertical Datum of 1988)

NGS Unpublished (City of Wheat Ridge Surveyed Point)

Combined Factors: 0.999747803 (ground to grid)

1.00025226062 (grid to ground - City Datum)

	<u>Northing</u>	<u>Easting</u>	
<u>SPCS:</u>	1710624.4313	3109716.0033	
<u>City Datum:</u>	711055.9545	110500.4621	(Millions truncated in City Datum)
<u>Height:</u>	5366.21	US Feet (Adjusted)	

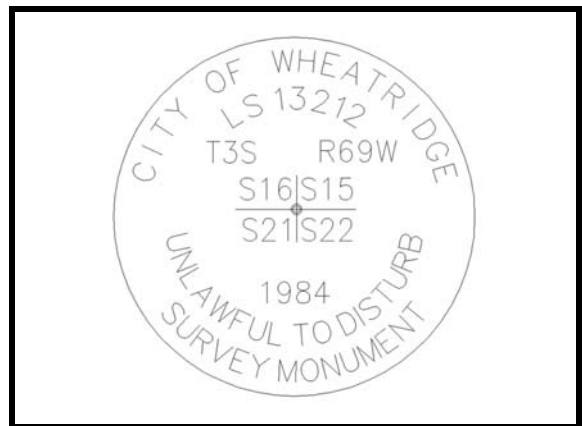
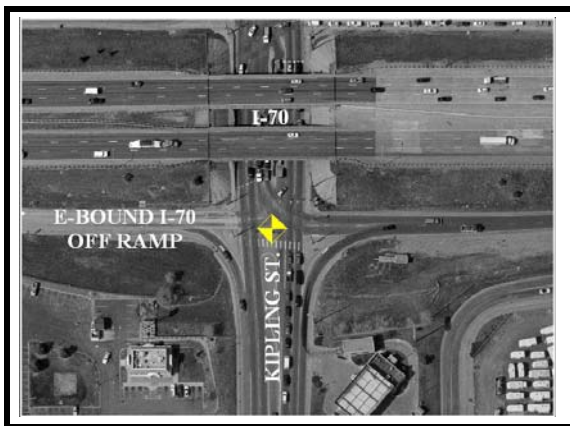

The monument is located in the City of Wheat Ridge, Colorado in Kipling Street at the eastbound I-70 off ramp.





## City of Wheat Ridge Survey Monument

**City Designation: POINT 12409**

**Monument Description:** East 1/4 Corner Section 16, T3S, R69W, of the 6th Principal Meridian.

(SPCS) State Plane Coordinate System, Colorado Central

FIPZONE: 502      ADSZONE: 3476      UTM ZONES: 12 & 13

State/County:      Colorado/Jefferson

Colorado Land Survey Master Index Number:      13-P

Horizontal Datum: NAD 83/92 – HARN (High Accuracy Reference Network) Based

Ellipsoid:      WGS 84 – (World Geodetic System of 1984)

Vertical Datum:      NAVD 88 – (North American Vertical Datum of 1988)

NGS Unpublished (City of Wheat Ridge Surveyed Point)

Combined Factors: 0.999747803 (ground to grid)

1.00025226062 (grid to ground - City Datum)

	<u>Northing</u>	<u>Easting</u>	
<u>SPCS:</u>	1713256.4797	3109706.4757	
<u>City Datum:</u>	713688.6668	110490.9322	(Millions truncated in City Datum)
<u>Height:</u>	5393.92	US Feet (Adjusted)	

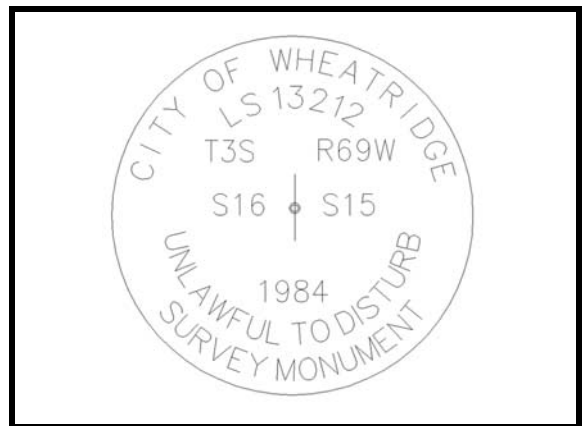

The monument is located in the City of Wheat Ridge, Colorado. To reach the monument, travel to the intersection of W. 52nd Avenue extended and Kipling Street.



## City of Wheat Ridge Survey Monument

**City Designation: POINT 16581**

**Monument Description:** South 1/4 Corner Section 27, T3S, R69W, of the 6th Principal Meridian.

**(SPCS) State Plane Coordinate System, Colorado Central**

**FIPZONE: 502      ADSZONE: 3476      UTM ZONES: 12 & 13**

**State/County:      Colorado/Jefferson**

**Colorado Land Survey Master Index Number:      15-E**

**Horizontal Datum: NAD 83/92 – HARN (High Accuracy Reference Network) Based**

**Ellipsoid:      WGS 84 – (World Geodetic System of 1984)**

**Vertical Datum:      NAVD 88 – (North American Vertical Datum of 1988)**

**NGS Unpublished (City of Wheat Ridge Surveyed Point)**

**Combined Factors: 0.999747803 (ground to grid)**

**1.00025226062 (grid to ground - City Datum)**

	<u>Northing</u>	<u>Easting</u>	
<b><u>SPCS:</u></b>	1700042.7875	3112393.3493	
<b><u>City Datum:</u></b>	700471.6413	107869.6467	(Millions truncated in City Datum)
<b><u>Height:</u></b>	5582.71	US Feet (Adjusted)	

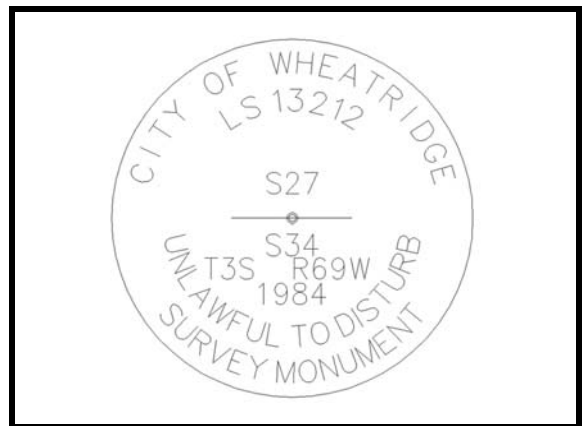

**The monument is located in the City of Wheat Ridge, Colorado in the intersection of W. 26th Ave. and Garrison St.**



## City of Wheat Ridge Survey Monument

**City Designation: POINT 16509**

**Monument Description:** Center 1/4 Corner Section 27, T3S, R69W, of the 6th Principal Meridian.

(SPCS) State Plane Coordinate System, Colorado Central

FIPSZONE: 502      ADSZONE: 3476      UTM ZONES: 12 & 13

State/County:      Colorado/Jefferson

Colorado Land Survey Master Index Number:      15-G

Horizontal Datum: NAD 83/92 – HARN (High Accuracy Reference Network) Based

Ellipsoid:      WGS 84 – (World Geodetic System of 1984)

Vertical Datum:      NAVD 88 – (North American Vertical Datum of 1988)

NGS Unpublished (City of Wheat Ridge Surveyed Point)

Combined Factors: 0.999747803 (ground to grid)

1.00025226062 (grid to ground - City Datum)

	<u>Northing</u>	<u>Easting</u>	
<u>SPCS:</u>	1702704.3725	3112385.5689	
<u>City Datum:</u>	703133.8978	113170.7012	(Millions truncated in City Datum)
<u>Height:</u>	5536.33	US Feet (Adjusted)	

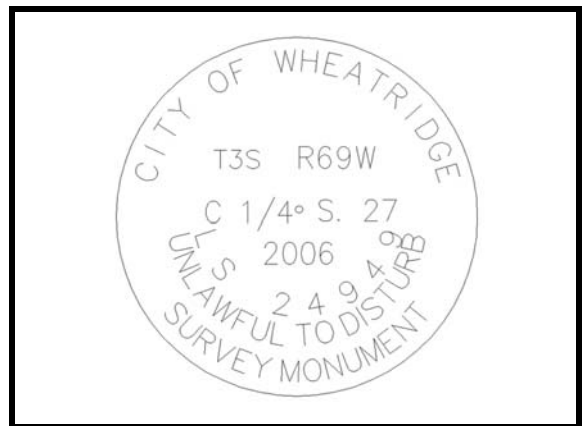

The monument is located in the City of Wheat Ridge, Colorado in W. 32nd Ave. near Garrison St.



## City of Wheat Ridge Survey Monument

**City Designation: POINT 15509**

**Monument Description:** South 1/4 Corner Section 22, T3S, R69W, of the 6th Principal Meridian.

(SPCS) State Plane Coordinate System, Colorado Central

FIPZONE: 502      ADSZONE: 3476      UTM ZONES: 12 & 13

State/County:      Colorado/Jefferson

Colorado Land Survey Master Index Number:      15-J

Horizontal Datum: NAD 83/92 – HARN (High Accuracy Reference Network) Based

Ellipsoid:      WGS 84 – (World Geodetic System of 1984)

Vertical Datum:      NAVD 88 – (North American Vertical Datum of 1988)

NGS Unpublished (City of Wheat Ridge Surveyed Point)

Combined Factors: 0.999747803 (ground to grid)

1.00025226062 (grid to ground - City Datum)

	<u>Northing</u>	<u>Easting</u>	
<u>SPCS:</u>	1705359.2861	3112377.9099	
<u>City Datum:</u>	705789.4811	113163.0403	(Millions truncated in City Datum)
<u>Height:</u>	5448.21	US Feet (Adjusted)	

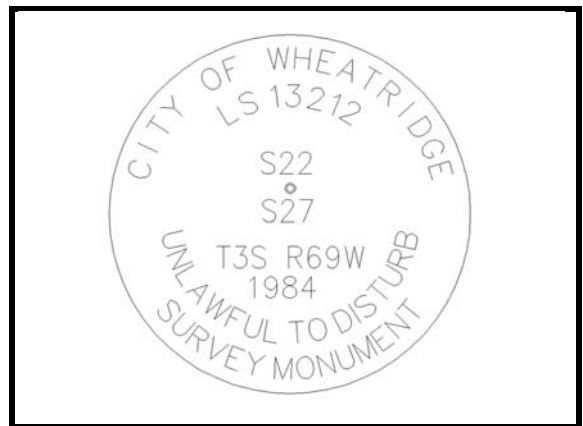

The monument is located in the City of Wheat Ridge, Colorado in the intersection of W. 38th Ave. and Garrison St.



## City of Wheat Ridge Survey Monument

**City Designation: POINT 14509**

**Monument Description:** Center 1/4 Corner Section 22, T3S, R69W, of the 6th Principal Meridian.

**(SPCS) State Plane Coordinate System, Colorado Central**

**FIPSZONE: 502      ADSZONE: 3476      UTM ZONES: 12 & 13**

**State/County:      Colorado/Jefferson**

**Colorado Land Survey Master Index Number:      15-L**

**Horizontal Datum: NAD 83/92 – HARN (High Accuracy Reference Network) Based**

**Ellipsoid:      WGS 84 – (World Geodetic System of 1984)**

**Vertical Datum:      NAVD 88 – (North American Vertical Datum of 1988)**

**NGS Unpublished (City of Wheat Ridge Surveyed Point)**

**Combined Factors: 0.999747803 (ground to grid)**

**1.00025226062 (grid to ground - City Datum)**

	<u>Northing</u>	<u>Easting</u>	
<b><u>SPCS:</u></b>	1707998.4558	3112367.4824	
<b><u>City Datum:</u></b>	708429.3165	113152.6102	(Millions truncated in City Datum)
<b><u>Height:</u></b>	5345.17	US Feet (Adjusted)	

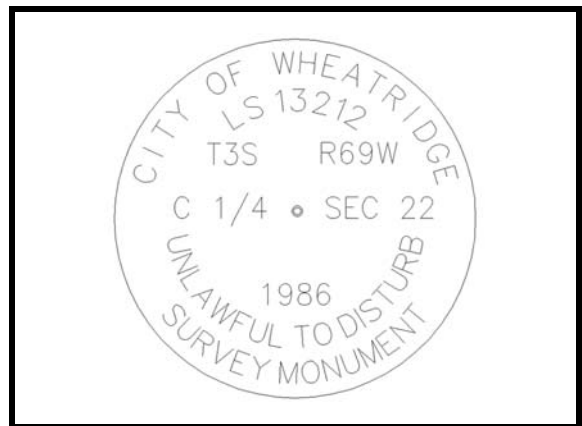

**The monument is located in the City of Wheat Ridge, Colorado approx. 150' east of the intersection of the westerly extension of W. 44th Ave. and Garrison St.**





## City of Wheat Ridge Survey Monument

**City Designation: POINT 13509**

**Monument Description:** South 1/4 Corner Section 15, T3S, R69W, of the 6th Principal Meridian.

**(SPCS) State Plane Coordinate System, Colorado Central**

**FIPSZONE: 502      ADSZONE: 3476      UTM ZONES: 12 & 13**

**State/County:      Colorado/Jefferson**

**Colorado Land Survey Master Index Number:      15-N**

**Horizontal Datum: NAD 83/92 – HARN (High Accuracy Reference Network) Based**

**Ellipsoid:      WGS 84 – (World Geodetic System of 1984)**

**Vertical Datum:      NAVD 88 – (North American Vertical Datum of 1988)**

**NGS Unpublished (City of Wheat Ridge Surveyed Point)**

**Combined Factors: 0.999747803 (ground to grid)**

**1.00025226062 (grid to ground - City Datum)**

	<u>Northing</u>	<u>Easting</u>	
<b><u>SPCS:</u></b>	1710640.9391	3112357.1960	
<b><u>City Datum:</u></b>	711072.4664	113142.3212	(Millions truncated in City Datum)
<b><u>Height:</u></b>	5345.35	US Feet (Adjusted)	

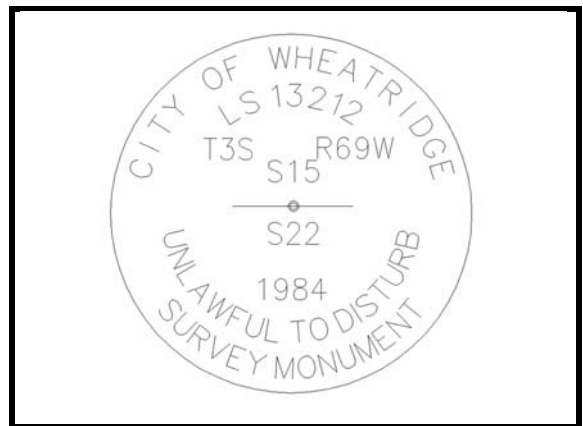
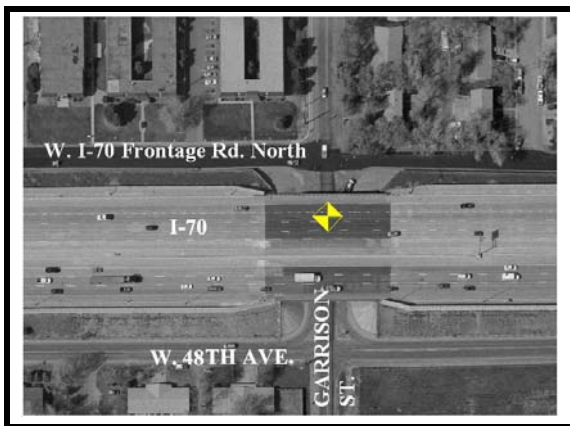

**The monument is located in the City of Wheat Ridge, Colorado underneath I-70 in Garrison Street north of W. 48 Avenue**





## City of Wheat Ridge Survey Monument

**City Designation: POINT 12509**

**Monument Description:** Center 1/4 Corner Section 15, T3S, R69W, of the 6th Principal Meridian.

(SPCS) State Plane Coordinate System, Colorado Central

FIPSZONE: 502      ADSZONE: 3476      UTM ZONES: 12 & 13

State/County:      Colorado/Jefferson

Colorado Land Survey Master Index Number:      15-P

Horizontal Datum: NAD 83/92 – HARN (High Accuracy Reference Network) Based

Ellipsoid:      WGS 84 – (World Geodetic System of 1984)

Vertical Datum:      NAVD 88 – (North American Vertical Datum of 1988)

NGS Unpublished (City of Wheat Ridge Surveyed Point)

Combined Factors: 0.999747803 (ground to grid)

1.00025226062 (grid to ground - City Datum)

	<u>Northing</u>	<u>Easting</u>	
<u>SPCS:</u>	1713280.4525	3112346.1450	
<u>City Datum:</u>	713712.6457	113131.2674	(Millions truncated in City Datum)
<u>Height:</u>	5359.90	US Feet (Adjusted)	

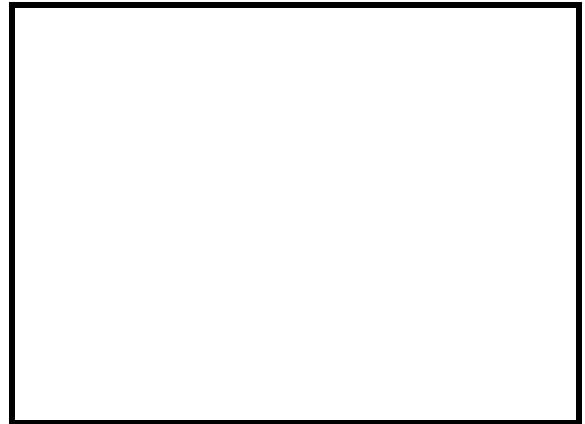

The monument is located in the City of Arvada, Colorado at the intersection of W. 52nd Ave to the east and Garrison St.



## City of Wheat Ridge Survey Monument

**City Designation: POINT 16681**

**Monument Description:** Southeast 1/4 Corner Section 27, T3S, R69W, of the 6th Principal Meridian.

(SPCS) State Plane Coordinate System, Colorado Central

FIPZONE: 502      ADSZONE: 3476      UTM ZONES: 12 & 13

State/County:      Colorado/Jefferson

Colorado Land Survey Master Index Number:      17-E

Horizontal Datum: NAD 83/92 – HARN (High Accuracy Reference Network) Based

Ellipsoid:      WGS 84 – (World Geodetic System of 1984)

Vertical Datum:      NAVD 88 – (North American Vertical Datum of 1988)

NGS Unpublished (City of Wheat Ridge Surveyed Point)

Combined Factors: 0.999747803 (ground to grid)

1.00025226062 (grid to ground - City Datum)

	<u>Northing</u>	<u>Easting</u>	
<u>SPCS:</u>	1700075.2048	3115044.1288	
<u>City Datum:</u>	700504.0668	115829.9317	(Millions truncated in City Datum)
<u>Height:</u>	5531.07	US Feet (Adjusted)	



The monument is located in the City of Wheat Ridge, Colorado in the intersection of W. 26th Ave. and Carr St.



## City of Wheat Ridge Survey Monument

**City Designation: POINT 16609**

**Monument Description:** East 1/4 Corner Section 27, T3S, R69W, of the 6th Principal Meridian.

(SPCS) State Plane Coordinate System, Colorado Central

FIPSZONE: 502      ADSZONE: 3476      UTM ZONES: 12 & 13

State/County:      Colorado/Jefferson

Colorado Land Survey Master Index Number:      17-G

Horizontal Datum: NAD 83/92 – HARN (High Accuracy Reference Network) Based

Ellipsoid:      WGS 84 – (World Geodetic System of 1984)

Vertical Datum:      NAVD 88 – (North American Vertical Datum of 1988)

NGS Unpublished (City of Wheat Ridge Surveyed Point)

Combined Factors: 0.999747803 (ground to grid)

1.00025226062 (grid to ground - City Datum)

	<u>Northing</u>	<u>Easting</u>	
<u>SPCS:</u>	1702727.5396	3115030.7849	
<u>City Datum:</u>	703157.0707	115816.5845	(Millions truncated in City Datum)
<u>Height:</u>	5534.28	US Feet (Adjusted)	

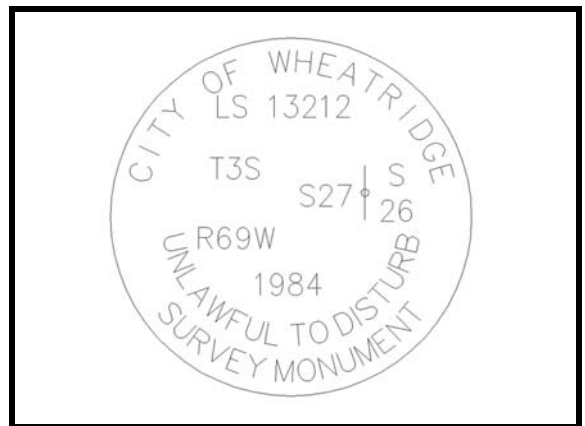

The monument is located in the City of Wheat Ridge, Colorado in the intersection of W. 32nd Ave. and Lutheran Pkwy (Carr St. extended).



# City of Wheat Ridge Survey Monument

**City Designation: POINT 15609**

**Monument Description:** Northeast Corner Section 27, T3S, R69W, of the 6th Principal Meridian.

(SPCS) State Plane Coordinate System, Colorado Central

FIPSZONE: 502      ADSZONE: 3476      UTM ZONES: 12 & 13

State/County:      Colorado/Jefferson

Colorado Land Survey Master Index Number:      17-J

Horizontal Datum: NAD 83/92 – HARN (High Accuracy Reference Network) Based

Ellipsoid:      WGS 84 – (World Geodetic System of 1984)

Vertical Datum:      NAVD 88 – (North American Vertical Datum of 1988)

NGS Unpublished (City of Wheat Ridge Surveyed Point)

Combined Factors: 0.999747803 (ground to grid)

1.00025226062 (grid to ground - City Datum)

	<u>Northing</u>	<u>Easting</u>	
<u>SPCS:</u>	1705376.3875	3115027.7108	
<u>City Datum:</u>	705806.5868	115813.5096	(Millions truncated in City Datum)
<u>Height:</u>	5492.37	US Feet (Adjusted)	

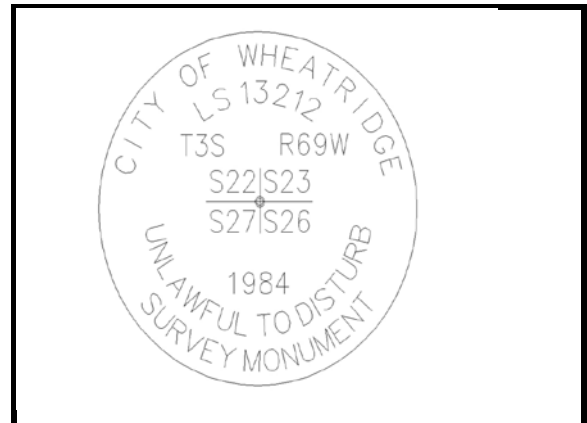

The monument is located in the City of Wheat Ridge, Colorado in the intersection of W. 38th Ave. and Carr St.



## City of Wheat Ridge Survey Monument

**City Designation: POINT 14609**

**Monument Description:** East 1/4 Corner Section 22, T3S, R69W, of the 6th Principal Meridian.

(SPCS) State Plane Coordinate System, Colorado Central

FIPZONE: 502      ADSZONE: 3476      UTM ZONES: 12 & 13

State/County:      Colorado/Jefferson

Colorado Land Survey Master Index Number:      17-L

Horizontal Datum: NAD 83/92 – HARN (High Accuracy Reference Network) Based

Ellipsoid:      WGS 84 – (World Geodetic System of 1984)

Vertical Datum:      NAVD 88 – (North American Vertical Datum of 1988)

NGS Unpublished (City of Wheat Ridge Surveyed Point)

Combined Factors: 0.999747803 (ground to grid)

1.00025226062 (grid to ground - City Datum)

	<u>Northing</u>	<u>Easting</u>	
<u>SPCS:</u>	1708023.6725	3115012.4180	
<u>City Datum:</u>	708454.5396	115798.2130	(Millions truncated in City Datum)
<u>Height:</u>	5380.02	US Feet (Adjusted)	

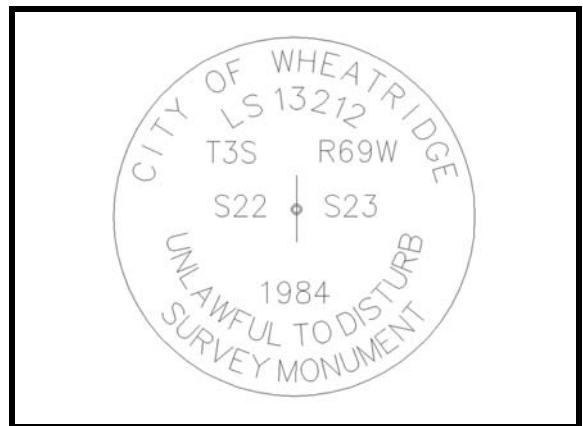

The monument is located in the City of Wheat Ridge, Colorado at the intersection of W. 44th Ave. and Carr St. to the south.



## City of Wheat Ridge Survey Monument

**City Designation: POINT 13609**

**Monument Description:** Northeast 1/4 Corner Section 17, T3S, R69W, of the 6th Principal Meridian.

(SPCS) State Plane Coordinate System, Colorado Central

FIPSZONE: 502      ADSZONE: 3476      UTM ZONES: 12 & 13

State/County:      Colorado/Jefferson

Colorado Land Survey Master Index Number:      17-N

Horizontal Datum: NAD 83/92 – HARN (High Accuracy Reference Network) Based

Ellipsoid:      WGS 84 – (World Geodetic System of 1984)

Vertical Datum:      NAVD 88 – (North American Vertical Datum of 1988)

NGS Unpublished (City of Wheat Ridge Surveyed Point)

Combined Factors: 0.999747803 (ground to grid)

1.00025226062 (grid to ground - City Datum)

	<u>Northing</u>	<u>Easting</u>	
<u>SPCS:</u>	1710657.2612	3114999.4622	
<u>City Datum:</u>	711088.7927	115785.2539	(Millions truncated in City Datum)
<u>Height:</u>	5326.26	US Feet (Adjusted)	

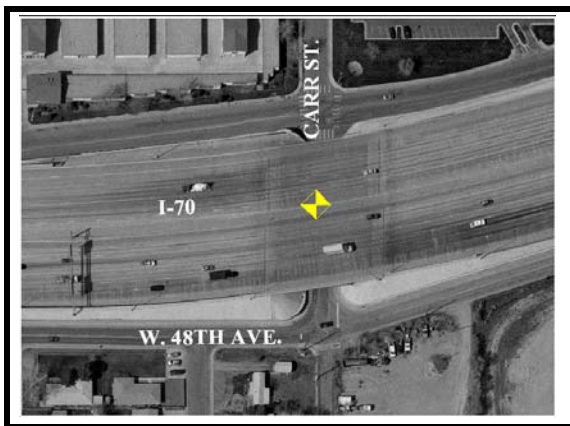

The monument is located in the City of Wheat Ridge, Colorado underneath I-70 in Carr Street north of W. 48th Avenue.





## City of Wheat Ridge Survey Monument

**City Designation: POINT 12609**

**Monument Description:** East 1/4 Corner Section 15, T3S, R69W, of the 6th Principal Meridian.

(SPCS) State Plane Coordinate System, Colorado Central

FIPZONE: 502      ADSZONE: 3476      UTM ZONES: 12 & 13

State/County:      Colorado/Jefferson

Colorado Land Survey Master Index Number:      17-P

Horizontal Datum: NAD 83/92 – HARN (High Accuracy Reference Network) Based

Ellipsoid:      WGS 84 – (World Geodetic System of 1984)

Vertical Datum:      NAVD 88 – (North American Vertical Datum of 1988)

NGS Unpublished (City of Wheat Ridge Surveyed Point)

Combined Factors: 0.999747803 (ground to grid)

1.00025226062 (grid to ground - City Datum)

	<u>Northing</u>	<u>Easting</u>	
<u>SPCS:</u>	1713304.6840	3114986.0394	
<u>City Datum:</u>	713736.8833	115771.8277	(Millions truncated in City Datum)
<u>Height:</u>	5324.37	US Feet (Adjusted)	

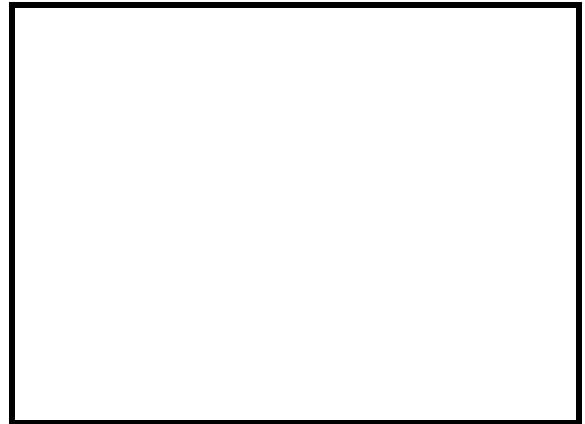

The monument is located in the City of Arvada, Colorado in the intersection of W. 52nd Ave. and Carr St.



## City of Wheat Ridge Survey Monument

**City Designation: POINT 16781**

**Monument Description:** South 1/4 Corner Section 26, T3S, R69W, of the 6th Principal Meridian.

(SPCS) State Plane Coordinate System, Colorado Central

FIPZONE: 502      ADSZONE: 3476      UTM ZONES: 12 & 13

State/County:      Colorado/Jefferson

Colorado Land Survey Master Index Number:      19-E

Horizontal Datum: NAD 83/92 – HARN (High Accuracy Reference Network) Based

Ellipsoid:      WGS 84 – (World Geodetic System of 1984)

Vertical Datum:      NAVD 88 – (North American Vertical Datum of 1988)

NGS Unpublished (City of Wheat Ridge Surveyed Point)

Combined Factors: 0.999747803 (ground to grid)

1.00025226062 (grid to ground - City Datum)

	<u>Northing</u>	<u>Easting</u>	
<u>SPCS:</u>	1700095.5890	3117686.7995	
<u>City Datum:</u>	700524.4562	118473.2691	(Millions truncated in City Datum)
<u>Height:</u>	5478.01	US Feet (Adjusted)	

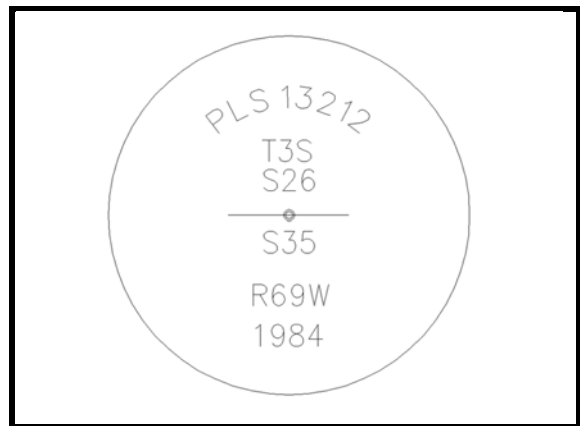

The monument is located in the City of Wheat Ridge, Colorado in the intersection of W. 26th Ave. and Wadsworth Blvd.



## City of Wheat Ridge Survey Monument

**City Designation: POINT 16709**

**Monument Description:** Center 1/4 Corner Section 26, T3S, R69W, of the 6th Principal Meridian.

(SPCS) State Plane Coordinate System, Colorado Central

FIPSZONE: 502      ADSZONE: 3476      UTM ZONES: 12 & 13

State/County:      Colorado/Jefferson

Colorado Land Survey Master Index Number:      19-G

Horizontal Datum: NAD 83/92 – HARN (High Accuracy Reference Network) Based

Ellipsoid:      WGS 84 – (World Geodetic System of 1984)

Vertical Datum:      NAVD 88 – (North American Vertical Datum of 1988)

NGS Unpublished (City of Wheat Ridge Surveyed Point)

Combined Factors: 0.999747803 (ground to grid)

1.00025226062 (grid to ground - City Datum)

	<u>Northing</u>	<u>Easting</u>	
<u>SPCS:</u>	1702739.0340	3117671.7834	
<u>City Datum:</u>	703168.5680	118458.2492	(Millions truncated in City Datum)
<u>Height:</u>	5491.46	US Feet (Adjusted)	

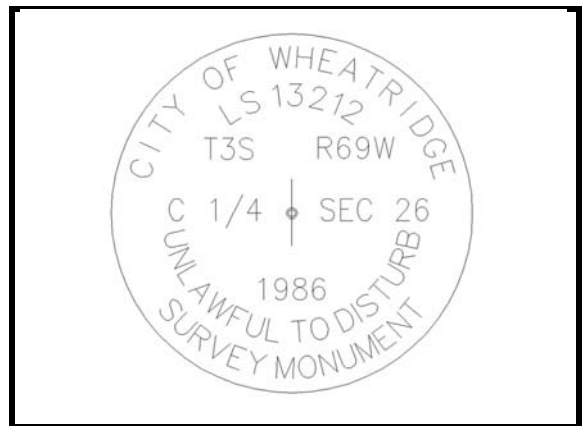

The monument is located in the City of Wheat Ridge, Colorado in the intersection of W. 32nd Ave. and Wadsworth Blvd.



## City of Wheat Ridge Survey Monument

**City Designation: POINT 160007**

**Monument Description:** 1/16 Corner Section 21, T3S, R69W, of the 6th Principal Meridian.

(SPCS) State Plane Coordinate System, Colorado Central

FIPZONE: 502      ADSZONE: 3476      UTM ZONES: 12 & 13

State/County:      Colorado/Jefferson

Colorado Land Survey Master Index Number:      19-H

Horizontal Datum: NAD 83/92 – HARN (High Accuracy Reference Network) Based

Ellipsoid:      WGS 84 – (World Geodetic System of 1984)

Vertical Datum:      NAVD 88 – (North American Vertical Datum of 1988)

NGS Unpublished (City of Wheat Ridge Surveyed Point)

Combined Factors: 0.999747803 (ground to grid)

1.00025226062 (grid to ground - City Datum)

	<u>Northing</u>	<u>Easting</u>	
<u>SPCS:</u>	1704066.1517	3117664.2966	
<u>City Datum:</u>	704496.0205	118450.7605	(Millions truncated in City Datum)
<u>Height:</u>	5459.52	US Feet (Adjusted)	

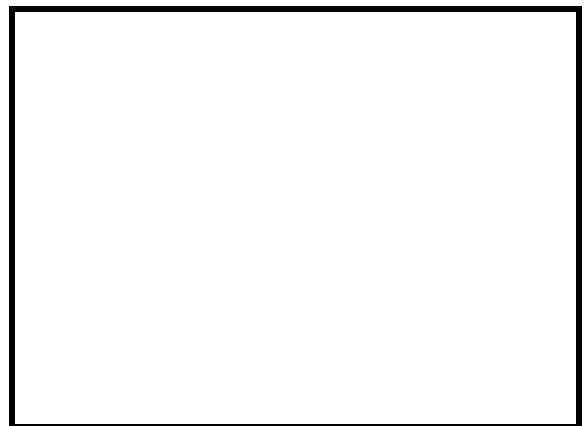

The monument is located in the City of Wheat Ridge, Colorado in the intersection of W. 35th Ave. and Wadsworth Blvd.



## City of Wheat Ridge Survey Monument

**City Designation: POINT 15709**

**Monument Description:** South 1/4 Corner Section 21, T3S, R69W, of the 6th Principal Meridian.

(SPCS) State Plane Coordinate System, Colorado Central

FIPSZONE: 502      ADSZONE: 3476      UTM ZONES: 12 & 13

State/County:      Colorado/Jefferson

Colorado Land Survey Master Index Number:      19-J

Horizontal Datum: NAD 83/92 – HARN (High Accuracy Reference Network) Based

Ellipsoid:      WGS 84 – (World Geodetic System of 1984)

Vertical Datum:      NAVD 88 – (North American Vertical Datum of 1988)

NGS Unpublished (City of Wheat Ridge Surveyed Point)

Combined Factors: 0.999747803 (ground to grid)

1.00025226062 (grid to ground - City Datum)

	<u>Northing</u>	<u>Easting</u>	
<u>SPCS:</u>	1705393.2792	3117656.7852	
<u>City Datum:</u>	705823.4828	118443.2472	(Millions truncated in City Datum)
<u>Height:</u>	5447.48	US Feet (Adjusted)	

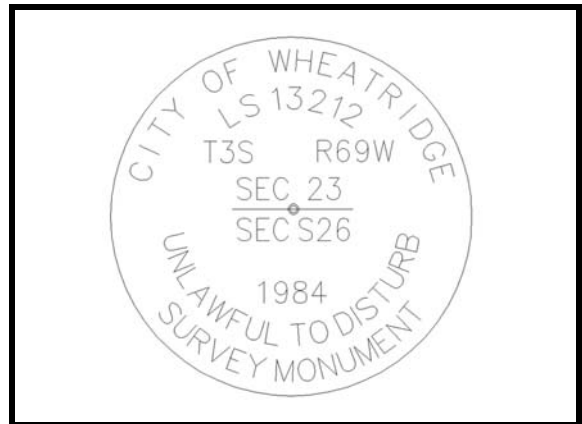

The monument is located in the City of Wheat Ridge, Colorado in the intersection of W. 38th Ave. and Wadsworth Blvd.



## City of Wheat Ridge Survey Monument

**City Designation: POINT 160008**

**Monument Description:** 1/16 Corner Section 23, T3S, R69W, of the 6th Principal Meridian.

(SPCS) State Plane Coordinate System, Colorado Central

FIPZONE: 502      ADSZONE: 3476      UTM ZONES: 12 & 13

State/County:      Colorado/Jefferson

Colorado Land Survey Master Index Number:      19-K

Horizontal Datum: NAD 83/92 – HARN (High Accuracy Reference Network) Based

Ellipsoid:      WGS 84 – (World Geodetic System of 1984)

Vertical Datum:      NAVD 88 – (North American Vertical Datum of 1988)

NGS Unpublished (City of Wheat Ridge Surveyed Point)

Combined Factors: 0.999747803 (ground to grid)

1.00025226062 (grid to ground - City Datum)

	<u>Northing</u>	<u>Easting</u>	
<u>SPCS:</u>	1706715.4145	3117652.7900	
<u>City Datum:</u>	707145.9516	118439.2510	(Millions truncated in City Datum)
<u>Height:</u>	5428.81	US Feet (Adjusted)	

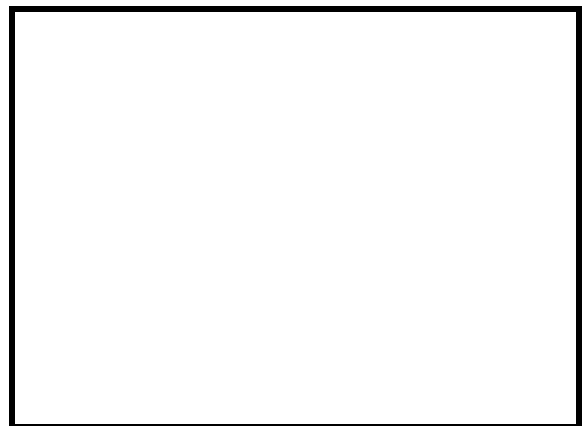

The monument is located in the City of Wheat Ridge, Colorado in the intersection of W. 41st Ave. and Wadsworth Blvd.





## City of Wheat Ridge Survey Monument

**City Designation: POINT 14709**

**Monument Description:** Center 1/4 Corner Section 23, T3S, R69W, of the 6th Principal Meridian.

(SPCS) State Plane Coordinate System, Colorado Central

FIPSZONE: 502      ADSZONE: 3476      UTM ZONES: 12 & 13

State/County:      Colorado/Jefferson

Colorado Land Survey Master Index Number:      19-L

Horizontal Datum: NAD 83/92 – HARN (High Accuracy Reference Network) Based

Ellipsoid:      WGS 84 – (World Geodetic System of 1984)

Vertical Datum:      NAVD 88 – (North American Vertical Datum of 1988)

NGS Unpublished (City of Wheat Ridge Surveyed Point)

Combined Factors: 0.999747803 (ground to grid)

1.00025226062 (grid to ground - City Datum)

	<u>Northing</u>	<u>Easting</u>	
<u>SPCS:</u>	1708037.6445	3117648.9228	
<u>City Datum:</u>	708468.5151	118435.3828	(Millions truncated in City Datum)
<u>Height:</u>	5403.20	US Feet (Adjusted)	

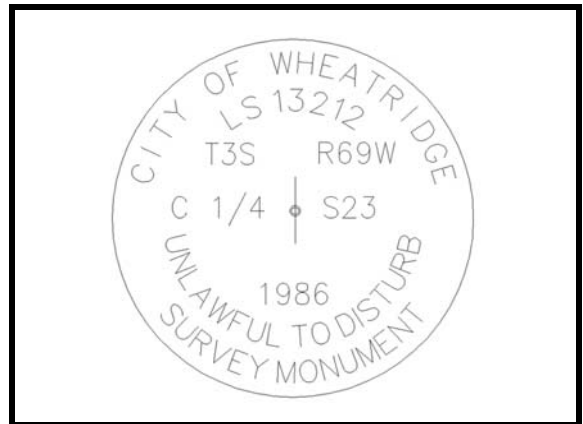

The monument is located in the City of Wheat Ridge, Colorado in the intersection of W. 44th Ave. and Wadsworth Blvd.



## City of Wheat Ridge Survey Monument

**City Designation: POINT 160009**

**Monument Description:** 1/16 Corner Section 23, T3S, R69W, of the 6th Principal Meridian.

(SPCS) State Plane Coordinate System, Colorado Central

FIPZONE: 502      ADSZONE: 3476      UTM ZONES: 12 & 13

State/County:      Colorado/Jefferson

Colorado Land Survey Master Index Number:      19-M

Horizontal Datum: NAD 83/92 – HARN (High Accuracy Reference Network) Based

Ellipsoid:      WGS 84 – (World Geodetic System of 1984)

Vertical Datum:      NAVD 88 – (North American Vertical Datum of 1988)

NGS Unpublished (City of Wheat Ridge Surveyed Point)

Combined Factors: 0.999747803 (ground to grid)

1.00025226062 (grid to ground - City Datum)

	<u>Northing</u>	<u>Easting</u>	
<u>SPCS:</u>	1709359.2870	3117645.0163	
<u>City Datum:</u>	709790.4910	118431.4753	(Millions truncated in City Datum)
<u>Height:</u>	5382.76	US Feet (Adjusted)	



The monument is located in the City of Wheat Ridge, Colorado in the intersection of W. 46th Ave. and Wadsworth Blvd..



## City of Wheat Ridge Survey Monument

**City Designation: POINT 13709**

**Monument Description:** South 1/4 Corner Section 14, T3S, R69W, of the 6th Principal Meridian.

(SPCS) State Plane Coordinate System, Colorado Central

FIPZONE: 502      ADSZONE: 3476      UTM ZONES: 12 & 13

State/County:      Colorado/Jefferson

Colorado Land Survey Master Index Number:      19-N

Horizontal Datum: NAD 83/92 – HARN (High Accuracy Reference Network) Based

Ellipsoid:      WGS 84 – (World Geodetic System of 1984)

Vertical Datum:      NAVD 88 – (North American Vertical Datum of 1988)

NGS Unpublished (City of Wheat Ridge Surveyed Point)

Combined Factors: 0.999747803 (ground to grid)

1.00025226062 (grid to ground - City Datum)

	<u>Northing</u>	<u>Easting</u>	
<u>SPCS:</u>	1710680.9027	3117641.1100	
<u>City Datum:</u>	711112.4401	118427.5681	(Millions truncated in City Datum)
<u>Height:</u>	5329.05	US Feet (Adjusted)	



The monument is located in the City of Wheat Ridge, Colorado at the extension of W. 48th Avenue and Wadsworth Blvd.



## City of Wheat Ridge Survey Monument

**City Designation: POINT 12709**

**Monument Description:** Center 1/4 Corner Section 14, T3S, R69W, of the 6th Principal Meridian.

(SPCS) State Plane Coordinate System, Colorado Central

FIPZONE: 502      ADSZONE: 3476      UTM ZONES: 12 & 13

State/County:      Colorado/Jefferson

Colorado Land Survey Master Index Number:      19-P

Horizontal Datum: NAD 83/92 – HARN (High Accuracy Reference Network) Based

Ellipsoid:      WGS 84 – (World Geodetic System of 1984)

Vertical Datum:      NAVD 88 – (North American Vertical Datum of 1988)

NGS Unpublished (City of Wheat Ridge Surveyed Point)

Combined Factors: 0.999747803 (ground to grid)

1.00025226062 (grid to ground - City Datum)

	<u>Northing</u>	<u>Easting</u>	
<u>SPCS:</u>	1713311.9072	3117623.7826	
<u>City Datum:</u>	713744.1083	118410.2363	(Millions truncated in City Datum)
<u>Height:</u>	5309.32	US Feet (Adjusted)	

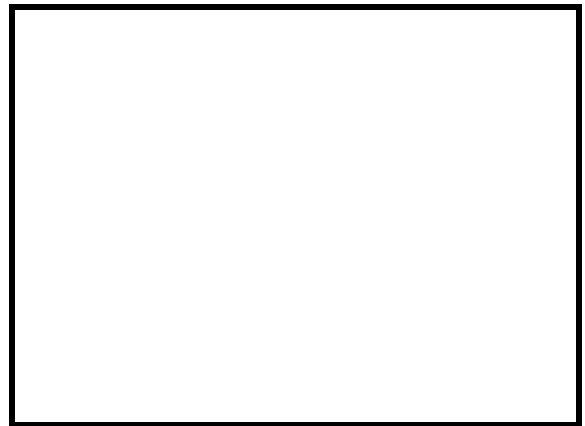

The monument is located in the City of Arvada, Colorado in the intersection of W. 52nd Ave. and Wadsworth Blvd.



## City of Wheat Ridge Survey Monument

**City Designation: POINT 16881**

**Monument Description:** Southeast 1/4 Corner Section 26, T3S, R69W, of the 6th Principal Meridian.

(SPCS) State Plane Coordinate System, Colorado Central

FIPZONE: 502      ADSZONE: 3476      UTM ZONES: 12 & 13

State/County:      Colorado/Jefferson

Colorado Land Survey Master Index Number:      21-E

Horizontal Datum: NAD 83/92 – HARN (High Accuracy Reference Network) Based

Ellipsoid:      WGS 84 – (World Geodetic System of 1984)

Vertical Datum:      NAVD 88 – (North American Vertical Datum of 1988)

NGS Unpublished (City of Wheat Ridge Surveyed Point)

Combined Factors: 0.999747803 (ground to grid)

1.00025226062 (grid to ground - City Datum)

	<u>Northing</u>	<u>Easting</u>	
<u>SPCS:</u>	1700111.6413	3120324.2998	
<u>City Datum:</u>	700540.5125	121111.4347	(Millions truncated in City Datum)
<u>Height:</u>	5411.07	US Feet (Adjusted)	

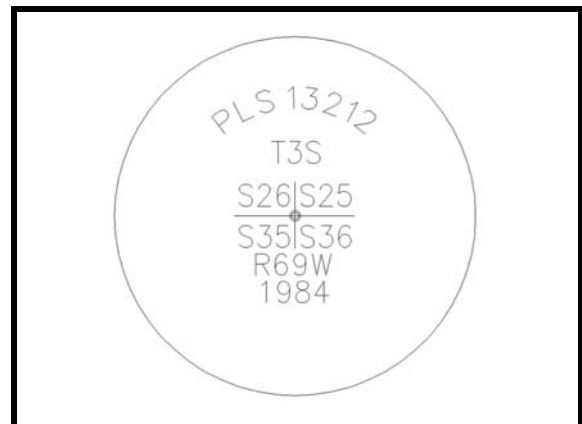

The monument is located in the City of Wheat Ridge, Colorado in the intersection of W. 26th Ave. and Pierce St.



# City of Wheat Ridge Survey Monument

**City Designation: POINT 160010**

**Monument Description:** 1/16 Corner Section 26, T3S, R69W, of the 6th Principal Meridian.

(SPCS) State Plane Coordinate System, Colorado Central

FIPZONE: 502      ADSZONE: 3476      UTM ZONES: 12 & 13

State/County:      Colorado/Jefferson

Colorado Land Survey Master Index Number:      21-F

Horizontal Datum: NAD 83/92 – HARN (High Accuracy Reference Network) Based

Ellipsoid:      WGS 84 – (World Geodetic System of 1984)

Vertical Datum:      NAVD 88 – (North American Vertical Datum of 1988)

NGS Unpublished (City of Wheat Ridge Surveyed Point)

Combined Factors: 0.999747803 (ground to grid)

1.00025226062 (grid to ground - City Datum)

	<u>Northing</u>	<u>Easting</u>	
<u>SPCS:</u>	1701431.1575	3120316.5118	
<u>City Datum:</u>	701860.3616	121103.6447	(Millions truncated in City Datum)
<u>Height:</u>	5446.25	US Feet (Adjusted)	

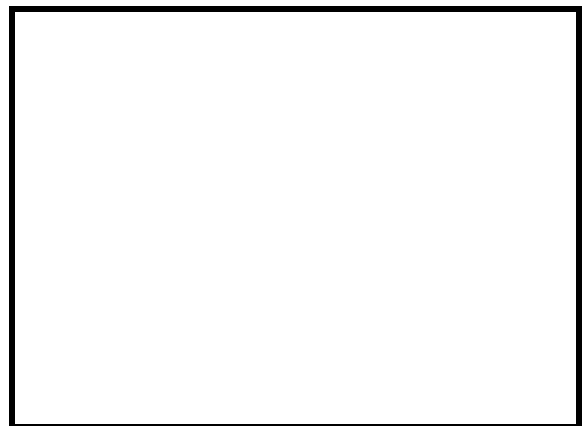

The monument is located in the City of Wheat Ridge, Colorado in the intersection of W. 29th Ave. and Pierce St.





## City of Wheat Ridge Survey Monument

**City Designation: POINT 16809**

**Monument Description:** East 1/4 Corner Section 26, T3S, R69W, of the 6th Principal Meridian.

(SPCS) State Plane Coordinate System, Colorado Central

FIPSZONE: 502      ADSZONE: 3476      UTM ZONES: 12 & 13

State/County:      Colorado/Jefferson

Colorado Land Survey Master Index Number:      21-G

Horizontal Datum: NAD 83/92 – HARN (High Accuracy Reference Network) Based

Ellipsoid:      WGS 84 – (World Geodetic System of 1984)

Vertical Datum:      NAVD 88 – (North American Vertical Datum of 1988)

NGS Unpublished (City of Wheat Ridge Surveyed Point)

Combined Factors: 0.999747803 (ground to grid)

1.00025226062 (grid to ground - City Datum)

	<u>Northing</u>	<u>Easting</u>	
<u>SPCS:</u>	1702750.6573	3120308.8265	
<u>City Datum:</u>	703180.1942	121095.9575	(Millions truncated in City Datum)
<u>Height:</u>	5451.55	US Feet (Adjusted)	

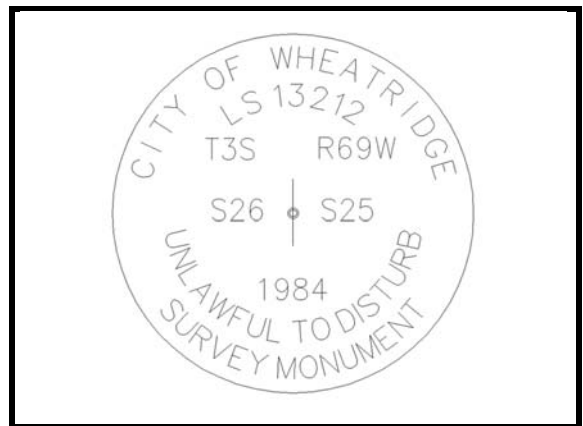

The monument is located in the City of Wheat Ridge, Colorado in the intersection of W. 32nd Ave. and Pierce St.



## City of Wheat Ridge Survey Monument

**City Designation: POINT 15809**

**Monument Description:** Northeast 1/4 Corner Section 26, T3S, R69W, of the 6th Principal Meridian.

(SPCS) State Plane Coordinate System, Colorado Central

FIPSZONE: 502      ADSZONE: 3476      UTM ZONES: 12 & 13

State/County:      Colorado/Jefferson

Colorado Land Survey Master Index Number:      21-J

Horizontal Datum: NAD 83/92 – HARN (High Accuracy Reference Network) Based

Ellipsoid:      WGS 84 – (World Geodetic System of 1984)

Vertical Datum:      NAVD 88 – (North American Vertical Datum of 1988)

NGS Unpublished (City of Wheat Ridge Surveyed Point)

Combined Factors: 0.999747803 (ground to grid)

1.00025226062 (grid to ground - City Datum)

	<u>Northing</u>	<u>Easting</u>	
<u>SPCS:</u>	1705409.8218	3120289.7281	
<u>City Datum:</u>	705840.0296	121076.8543	(Millions truncated in City Datum)
<u>Height:</u>	5428.16	US Feet (Adjusted)	

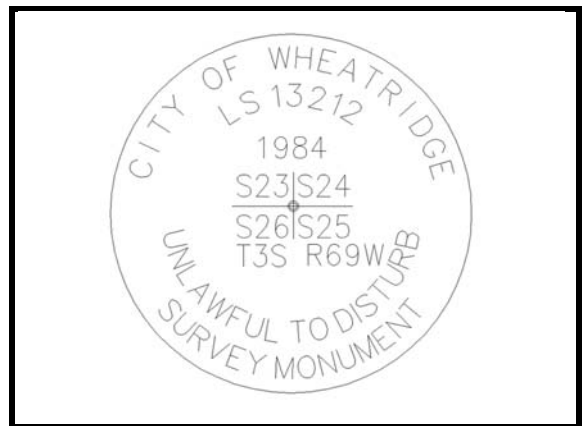

The monument is located in the City of Wheat Ridge, Colorado in the intersection of W. 38th Ave. and Pierce St.



## City of Wheat Ridge Survey Monument

**City Designation: POINT 14809**

**Monument Description:** East 1/4 Corner Section 23, T3S, R69W, of the 6th Principal Meridian.

(SPCS) State Plane Coordinate System, Colorado Central

FIPSZONE: 502      ADSZONE: 3476      UTM ZONES: 12 & 13

State/County:      Colorado/Jefferson

Colorado Land Survey Master Index Number:      21-L

Horizontal Datum: NAD 83/92 – HARN (High Accuracy Reference Network) Based

Ellipsoid:      WGS 84 – (World Geodetic System of 1984)

Vertical Datum:      NAVD 88 – (North American Vertical Datum of 1988)

NGS Unpublished (City of Wheat Ridge Surveyed Point)

Combined Factors: 0.999747803 (ground to grid)

1.00025226062 (grid to ground - City Datum)

	<u>Northing</u>	<u>Easting</u>	
<u>SPCS:</u>	1708051.7353	3120276.0595	
<u>City Datum:</u>	708482.6095	121063.1823	(Millions truncated in City Datum)
<u>Height:</u>	5391.18	US Feet (Adjusted)	

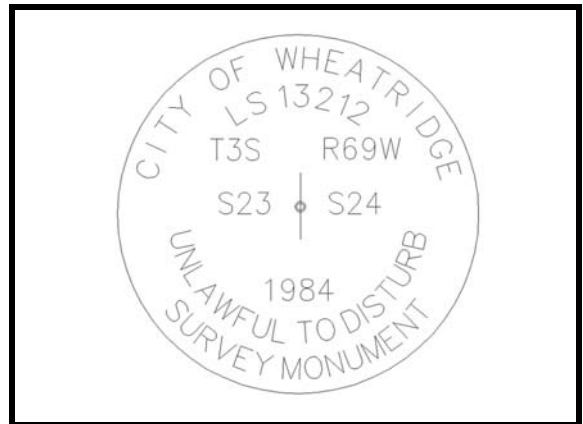
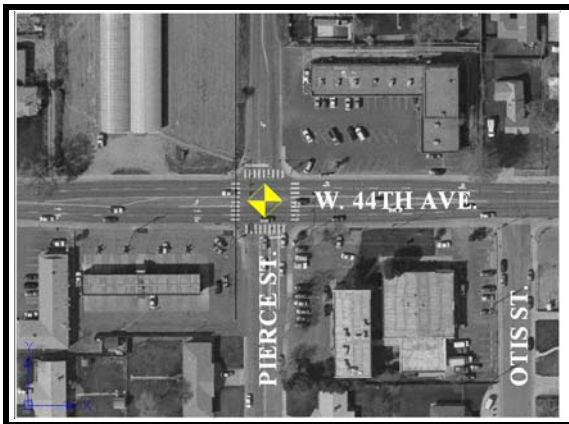

The monument is located in the City of Wheat Ridge, Colorado in the intersection of W. 44th Ave. and Pierce St.



## City of Wheat Ridge Survey Monument

**City Designation: POINT 13809**

**Monument Description:** Northeast 1/4 Corner Section 23, T3S, R69W, of the 6th Principal Meridian.

(SPCS) State Plane Coordinate System, Colorado Central

FIPSZONE: 502      ADSZONE: 3476      UTM ZONES: 12 & 13

State/County:      Colorado/Jefferson

Colorado Land Survey Master Index Number:      21-N

Horizontal Datum: NAD 83/92 – HARN (High Accuracy Reference Network) Based

Ellipsoid:      WGS 84 – (World Geodetic System of 1984)

Vertical Datum:      NAVD 88 – (North American Vertical Datum of 1988)

NGS Unpublished (City of Wheat Ridge Surveyed Point)

Combined Factors: 0.999747803 (ground to grid)

1.00025226062 (grid to ground - City Datum)

	<u>Northing</u>	<u>Easting</u>	
<u>SPCS:</u>	1710693.6180	3120265.7185	
<u>City Datum:</u>	711125.1586	121052.8387	(Millions truncated in City Datum)
<u>Height:</u>	5351.24	US Feet (Adjusted)	

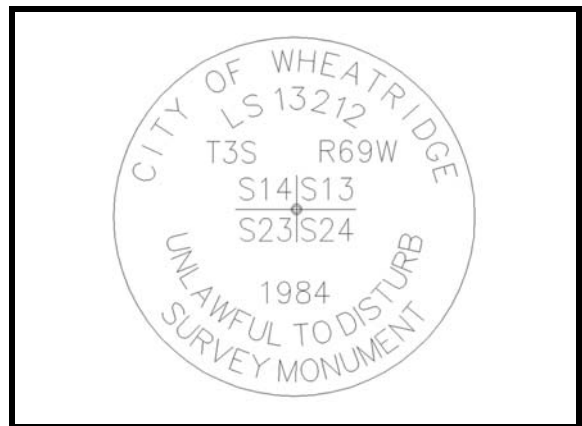

The monument is located in the City of Wheat Ridge, Colorado at the intersection of W. 48th Avenue & Pierce Street.



## City of Wheat Ridge Survey Monument

**City Designation: POINT 12809**

**Monument Description:** East 1/4 Corner Section 14, T3S, R69W, of the 6th Principal Meridian.

(SPCS) State Plane Coordinate System, Colorado Central

FIPZONE: 502      ADSZONE: 3476      UTM ZONES: 12 & 13

State/County:      Colorado/Jefferson

Colorado Land Survey Master Index Number:      21-P

Horizontal Datum: NAD 83/92 – HARN (High Accuracy Reference Network) Based

Ellipsoid:      WGS 84 – (World Geodetic System of 1984)

Vertical Datum:      NAVD 88 – (North American Vertical Datum of 1988)

NGS Unpublished (City of Wheat Ridge Surveyed Point)

Combined Factors: 0.999747803 (ground to grid)

1.00025226062 (grid to ground - City Datum)

	<u>Northing</u>	<u>Easting</u>	
<u>SPCS:</u>	1713319.0916	3120259.7040	
<u>City Datum:</u>	713751.2945	121046.8226	(Millions truncated in City Datum)
<u>Height:</u>	5289.16	US Feet (Adjusted)	



The monument is located in the City of Arvada, Colorado in the intersection of W. 52nd Ave. and Pierce St. extended.



## City of Wheat Ridge Survey Monument

**City Designation: POINT 160011**

**Monument Description:** 1/16 Corner Section 25, T3S, R69W, of the 6th Principal Meridian.

(SPCS) State Plane Coordinate System, Colorado Central

FIPSZONE: 502      ADSZONE: 3476      UTM ZONES: 12 & 13

State/County:      Colorado/Jefferson

Colorado Land Survey Master Index Number:      22-F

Horizontal Datum: NAD 83/92 – HARN (High Accuracy Reference Network) Based

Ellipsoid:      WGS 84 – (World Geodetic System of 1984)

Vertical Datum:      NAVD 88 – (North American Vertical Datum of 1988)

NGS Unpublished (City of Wheat Ridge Surveyed Point)

Combined Factors: 0.999747803 (ground to grid)

1.00025226062 (grid to ground - City Datum)

	<u>Northing</u>	<u>Easting</u>	
<u>SPCS:</u>	1701438.5468	3121638.2475	
<u>City Datum:</u>	701867.7527	122425.7139	(Millions truncated in City Datum)
<u>Height:</u>	5428.37	US Feet (Adjusted)	

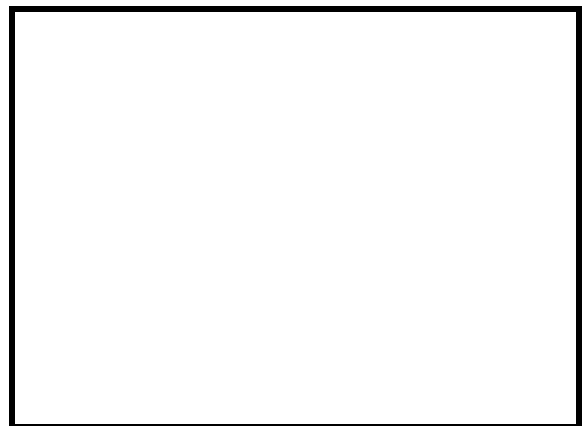

The monument is located in the City of Wheat Ridge, Colorado in the intersection of W. 29th Ave. and Lamar St.





## City of Wheat Ridge Survey Monument

**City Designation: POINT 16981**

**Monument Description:** South 1/4 Corner Section 25, T3S, R69W, of the 6th Principal Meridian.

(SPCS) State Plane Coordinate System, Colorado Central

FIPSZONE: 502      ADSZONE: 3476      UTM ZONES: 12 & 13

State/County:      Colorado/Jefferson

Colorado Land Survey Master Index Number:      23-E

Horizontal Datum: NAD 83/92 – HARN (High Accuracy Reference Network) Based

Ellipsoid:      WGS 84 – (World Geodetic System of 1984)

Vertical Datum:      NAVD 88 – (North American Vertical Datum of 1988)

NGS Unpublished (City of Wheat Ridge Surveyed Point)

Combined Factors: 0.999747803 (ground to grid)

1.00025226062 (grid to ground - City Datum)

	<u>Northing</u>	<u>Easting</u>	
<u>SPCS:</u>	1700127.5427	3122967.3548	
<u>City Datum:</u>	700556.4179	123755.1565	(Millions truncated in City Datum)
<u>Height:</u>	5364.00	US Feet (Adjusted)	

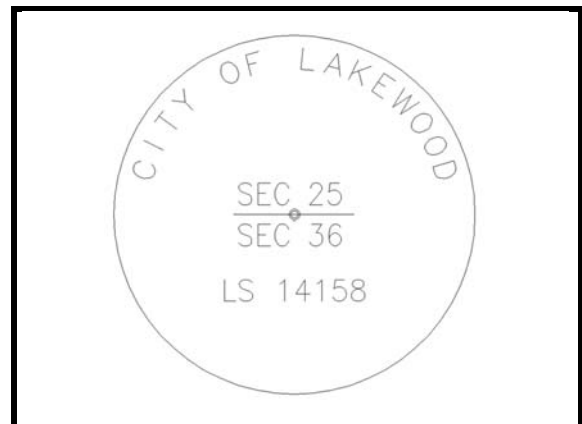

The monument is located in the City of Wheat Ridge, Colorado in the intersection of W. 26th Ave. and Harlan St.



# City of Wheat Ridge Survey Monument

**City Designation: POINT 160012**

**Monument Description:** 1/16 Corner Section 25, T3S, R69W, of the 6th Principal Meridian.

(SPCS) State Plane Coordinate System, Colorado Central

FIPZONE: 502      ADSZONE: 3476      UTM ZONES: 12 & 13

State/County:      Colorado/Jefferson

Colorado Land Survey Master Index Number:      23-F

Horizontal Datum: NAD 83/92 – HARN (High Accuracy Reference Network) Based

Ellipsoid:      WGS 84 – (World Geodetic System of 1984)

Vertical Datum:      NAVD 88 – (North American Vertical Datum of 1988)

NGS Unpublished (City of Wheat Ridge Surveyed Point)

Combined Factors: 0.999747803 (ground to grid)

1.00025226062 (grid to ground - City Datum)

	<u>Northing</u>	<u>Easting</u>	
<u>SPCS:</u>	1701446.1005	3122960.5233	
<u>City Datum:</u>	701875.3083	123748.3232	(Millions truncated in City Datum)
<u>Height:</u>	5417.23	US Feet (Adjusted)	

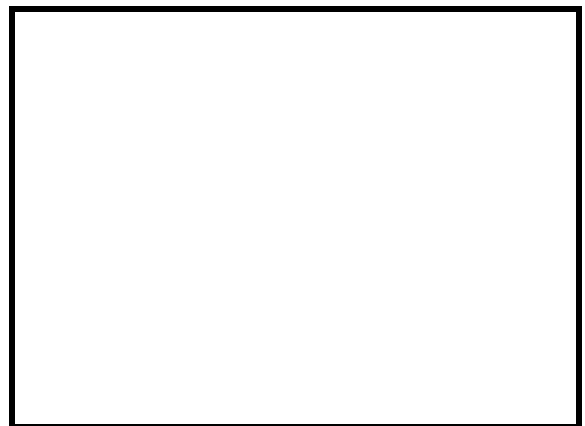
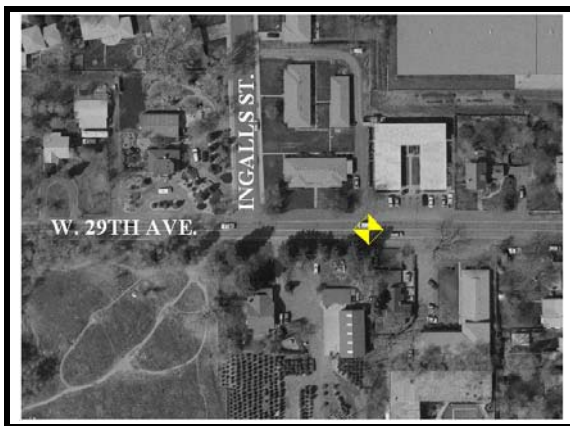

The monument is located in the City of Wheat Ridge, Colorado in the intersection of W. 29th Ave. and Harlan St. extended.



## City of Wheat Ridge Survey Monument

**City Designation: POINT 16909**

**Monument Description:** Center 1/4 Corner Section 25, T3S, R69W, of the 6th Principal Meridian.

(SPCS) State Plane Coordinate System, Colorado Central

FIPZONE: 502      ADSZONE: 3476      UTM ZONES: 12 & 13

State/County:      Colorado/Jefferson

Colorado Land Survey Master Index Number:      23-G

Horizontal Datum: NAD 83/92 – HARN (High Accuracy Reference Network) Based

Ellipsoid:      WGS 84 – (World Geodetic System of 1984)

Vertical Datum:      NAVD 88 – (North American Vertical Datum of 1988)

NGS Unpublished (City of Wheat Ridge Surveyed Point)

Combined Factors: 0.999747803 (ground to grid)

1.00025226062 (grid to ground - City Datum)

	<u>Northing</u>	<u>Easting</u>	
<u>SPCS:</u>	1702764.5220	3122952.6805	
<u>City Datum:</u>	703194.0624	123740.4785	(Millions truncated in City Datum)
<u>Height:</u>	5455.11	US Feet (Adjusted)	

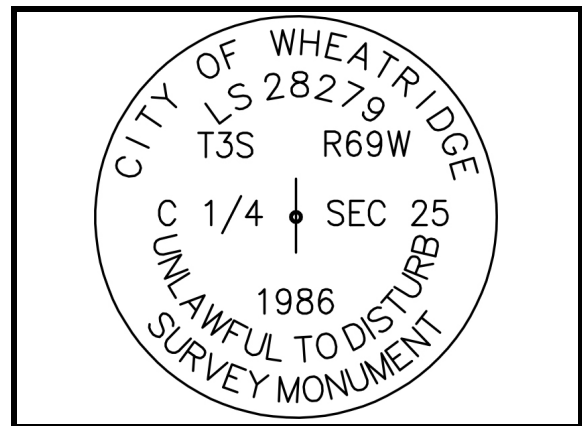

The monument is located in the City of Wheat Ridge, Colorado in the intersection of W. 32nd Ave. and Harlan St.



## City of Wheat Ridge Survey Monument

**City Designation: POINT 15909**

**Monument Description:** South 1/4 Corner Section 24, T3S, R69W, of the 6th Principal Meridian.

(SPCS) State Plane Coordinate System, Colorado Central

FIPSZONE: 502      ADSZONE: 3476      UTM ZONES: 12 & 13

State/County:      Colorado/Jefferson

Colorado Land Survey Master Index Number:      23-J

Horizontal Datum: NAD 83/92 – HARN (High Accuracy Reference Network) Based

Ellipsoid:      WGS 84 – (World Geodetic System of 1984)

Vertical Datum:      NAVD 88 – (North American Vertical Datum of 1988)

NGS Unpublished (City of Wheat Ridge Surveyed Point)

Combined Factors: 0.999747803 (ground to grid)

1.00025226062 (grid to ground - City Datum)

	<u>Northing</u>	<u>Easting</u>	
<u>SPCS:</u>	1705414.9318	3122937.9965	
<u>City Datum:</u>	705845.1409	123725.7908	(Millions truncated in City Datum)
<u>Height:</u>	5419.00	US Feet (Adjusted)	

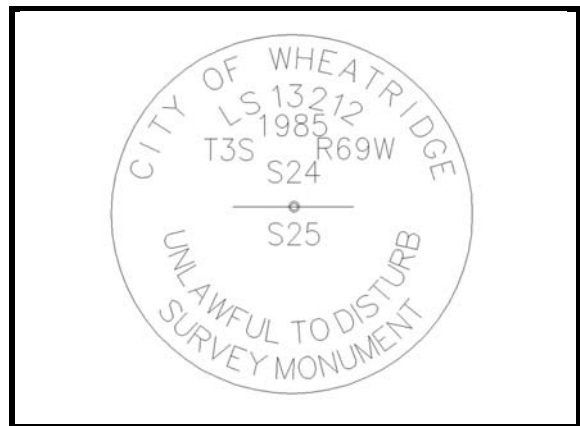

The monument is located in the City of Wheat Ridge, Colorado in the intersection of W. 38th Ave. and Harlan St.



## City of Wheat Ridge Survey Monument

**City Designation: POINT 160013**

**Monument Description:** 1/16 Corner Section 24, T3S, R69W, of the 6th Principal Meridian.

(SPCS) State Plane Coordinate System, Colorado Central

FIPSZONE: 502      ADSZONE: 3476      UTM ZONES: 12 & 13

State/County:      Colorado/Jefferson

Colorado Land Survey Master Index Number:      23-K

Horizontal Datum: NAD 83/92 – HARN (High Accuracy Reference Network) Based

Ellipsoid:      WGS 84 – (World Geodetic System of 1984)

Vertical Datum:      NAVD 88 – (North American Vertical Datum of 1988)

NGS Unpublished (City of Wheat Ridge Surveyed Point)

Combined Factors: 0.999747803 (ground to grid)

1.00025226062 (grid to ground - City Datum)

	<u>Northing</u>	<u>Easting</u>	
<u>SPCS:</u>	1706733.4922	3122931.8242	
<u>City Datum:</u>	707164.0338	107869.6467	(Millions truncated in City Datum)
<u>Height:</u>	5411.57	US Feet (Adjusted)	

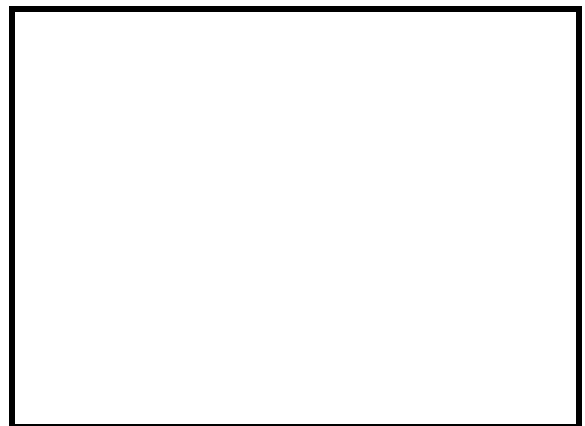

The monument is located in the City of Wheat Ridge, Colorado in the intersection of W. 41st Ave. and Harlan St.



## City of Wheat Ridge Survey Monument

**City Designation: POINT 14909**

**Monument Description:** Center 1/4 Corner Section 24, T3S, R69W, of the 6th Principal Meridian.

(SPCS) State Plane Coordinate System, Colorado Central

FIPZONE: 502      ADSZONE: 3476      UTM ZONES: 12 & 13

State/County:      Colorado/Jefferson

Colorado Land Survey Master Index Number:      23-L

Horizontal Datum: NAD 83/92 – HARN (High Accuracy Reference Network) Based

Ellipsoid:      WGS 84 – (World Geodetic System of 1984)

Vertical Datum:      NAVD 88 – (North American Vertical Datum of 1988)

NGS Unpublished (City of Wheat Ridge Surveyed Point)

Combined Factors: 0.999747803 (ground to grid)

1.00025226062 (grid to ground - City Datum)

	<u>Northing</u>	<u>Easting</u>	
<u>SPCS:</u>	1708052.8898	3122925.0980	
<u>City Datum:</u>	708483.7642	123712.8890	(Millions truncated in City Datum)
<u>Height:</u>	5373.62	US Feet (Adjusted)	

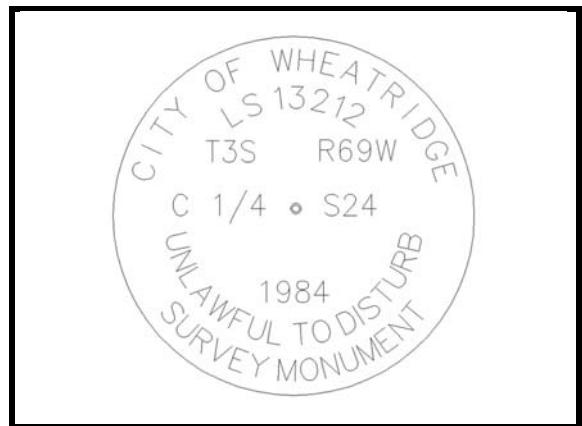

The monument is located in the City of Wheat Ridge, Colorado in the intersection of W. 44th Ave. and Harlan St.





# City of Wheat Ridge Survey Monument

**City Designation: POINT 13909**

**Monument Description:** South 1/4 Corner Section 13, T3S, R69W, of the 6th Principal Meridian.

(SPCS) State Plane Coordinate System, Colorado Central

FIPSZONE: 502      ADSZONE: 3476      UTM ZONES: 12 & 13

State/County:      Colorado/Jefferson

Colorado Land Survey Master Index Number:      23-N

Horizontal Datum: NAD 83/92 – HARN (High Accuracy Reference Network) Based

Ellipsoid:      WGS 84 – (World Geodetic System of 1984)

Vertical Datum:      NAVD 88 – (North American Vertical Datum of 1988)

NGS Unpublished (City of Wheat Ridge Surveyed Point)

Combined Factors: 0.999747803 (ground to grid)

1.00025226062 (grid to ground - City Datum)

	<u>Northing</u>	<u>Easting</u>	
<u>SPCS:</u>	1710693.6687	3122912.2240	
<u>City Datum:</u>	711125.2093	123700.0118	(Millions truncated in City Datum)
<u>Height:</u>	5332.31	US Feet (Adjusted)	

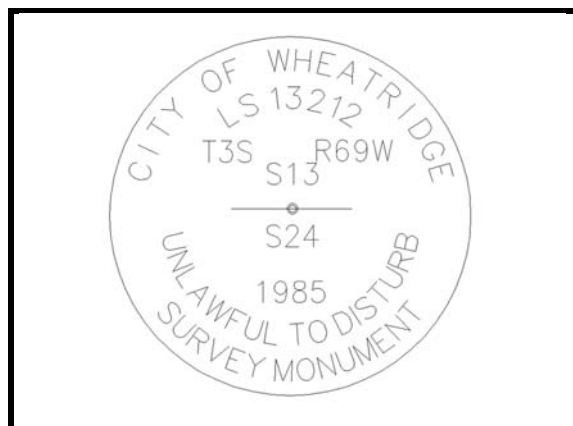
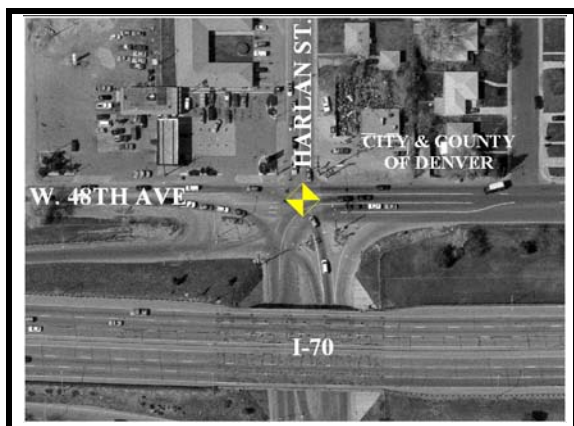

The monument is located in the City of Wheat Ridge, Colorado in the intersection of W. 48th Avenue & Harlan Street.



## City of Wheat Ridge Survey Monument

**City Designation: POINT 12909**

**Monument Description:** Center 1/4 Corner Section 13, T3S, R69W, of the 6th Principal Meridian.

(SPCS) State Plane Coordinate System, Colorado Central

FIPZONE: 502      ADSZONE: 3476      UTM ZONES: 12 & 13

State/County:      Colorado/Jefferson

Colorado Land Survey Master Index Number:      23-P

Horizontal Datum: NAD 83/92 – HARN (High Accuracy Reference Network) Based

Ellipsoid:      WGS 84 – (World Geodetic System of 1984)

Vertical Datum:      NAVD 88 – (North American Vertical Datum of 1988)

NGS Unpublished (City of Wheat Ridge Surveyed Point)

Combined Factors: 0.999747803 (ground to grid)

1.00025226062 (grid to ground - City Datum)

	<u>Northing</u>	<u>Easting</u>	
<u>SPCS:</u>	1713326.7582	3122903.4398	
<u>City Datum:</u>	713758.9631	123691.2254	(Millions truncated in City Datum)
<u>Height:</u>	5277.11	US Feet (Adjusted)	



The monument is located in the City of Arvada, Colorado under the I-76 overpass over W. 52nd Ave. (also known as the intersection of W. 52nd Ave. and Harlan St. extended).



## City of Wheat Ridge Survey Monument

**City Designation: POINT 16973**

**Monument Description:** Southeast 1/4 Corner Section 25, T3S, R69W, of the 6th Principal Meridian.

(SPCS) State Plane Coordinate System, Colorado Central

FIPSZONE: 502    ADSZONE: 3476    UTM ZONES: 12 & 13

State/County:    Colorado/Jefferson

Colorado Land Survey Master Index Number:    25-E

Horizontal Datum: NAD 83/92 – HARN (High Accuracy Reference Network) Based

Ellipsoid:    WGS 84 – (World Geodetic System of 1984)

Vertical Datum:    NAVD 88 – (North American Vertical Datum of 1988)

NGS Unpublished (City of Wheat Ridge Surveyed Point)

Combined Factors: 0.999747803 (ground to grid)

1.00025226062 (grid to ground - City Datum)

	<u>Northing</u>	<u>Easting</u>	
<u>SPCS:</u>	1700142.8896	3125612.8047	
<u>City Datum:</u>	700571.7687	126401.2737	(Millions truncated in City Datum)
<u>Height:</u>	5357.25	US Feet (Adjusted)	

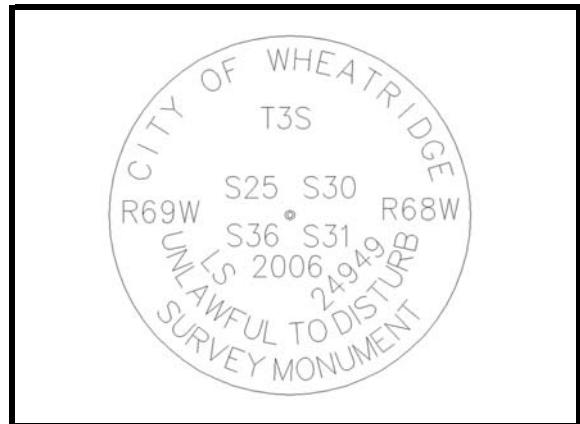

The monument is located in the City of Edgewater, Colorado in the intersection of W. 26th Ave. and Sheridan Blvd.



## City of Wheat Ridge Survey Monument

**City Designation: POINT 16901**

**Monument Description:** East 1/4 Corner Section 25, T3S, R69W, of the 6th Principal Meridian.

(SPCS) State Plane Coordinate System, Colorado Central

FIPSZONE: 502      ADSZONE: 3476      UTM ZONES: 12 & 13

State/County:      Colorado/Jefferson

Colorado Land Survey Master Index Number:      25-G

Horizontal Datum: NAD 83/92 – HARN (High Accuracy Reference Network) Based

Ellipsoid:      WGS 84 – (World Geodetic System of 1984)

Vertical Datum:      NAVD 88 – (North American Vertical Datum of 1988)

NGS Unpublished (City of Wheat Ridge Surveyed Point)

Combined Factors: 0.999747803 (ground to grid)

1.00025226062 (grid to ground - City Datum)

	<u>Northing</u>	<u>Easting</u>	
<u>SPCS:</u>	1702778.6063	3125597.6855	
<u>City Datum:</u>	703208.1502	126386.1507	(Millions truncated in City Datum)
<u>Height:</u>	5467.12	US Feet (Adjusted)	



The monument is located in the City of Wheat Ridge, Colorado in the intersection of W. 32nd Ave. and Sheridan Blvd.



# City of Wheat Ridge Survey Monument

**City Designation: POINT 15901**

**Monument Description:** Northeast 1/4 Corner Section 25, T3S, R69W, of the 6th Principal Meridian.

(SPCS) State Plane Coordinate System, Colorado Central

FIPSZONE: 502      ADSZONE: 3476      UTM ZONES: 12 & 13

State/County:      Colorado/Jefferson

Colorado Land Survey Master Index Number:      25-J

Horizontal Datum: NAD 83/92 – HARN (High Accuracy Reference Network) Based

Ellipsoid:      WGS 84 – (World Geodetic System of 1984)

Vertical Datum:      NAVD 88 – (North American Vertical Datum of 1988)

NGS Unpublished (City of Wheat Ridge Surveyed Point)

Combined Factors: 0.999747803 (ground to grid)

1.00025226062 (grid to ground - City Datum)

	<u>Northing</u>	<u>Easting</u>	
<u>SPCS:</u>	1705414.8938	3125585.4688	
<u>City Datum:</u>	705845.1028	126373.9309	(Millions truncated in City Datum)
<u>Height:</u>	5421.39	US Feet (Adjusted)	



The monument is located in the City of Wheat Ridge, Colorado in the intersection of W. 38th Ave. and Sheridan Blvd.



# City of Wheat Ridge Survey Monument

**City Designation: POINT 14901**

**Monument Description:** East 1/4 Corner Section 24, T3S, R69W, of the 6th Principal Meridian.

(SPCS) State Plane Coordinate System, Colorado Central

FIPZONE: 502      ADSZONE: 3476      UTM ZONES: 12 & 13

State/County:      Colorado/Jefferson

Colorado Land Survey Master Index Number:      25-L

Horizontal Datum: NAD 83/92 – HARN (High Accuracy Reference Network) Based

Ellipsoid:      WGS 84 – (World Geodetic System of 1984)

Vertical Datum:      NAVD 88 – (North American Vertical Datum of 1988)

NGS Unpublished (City of Wheat Ridge Surveyed Point)

Combined Factors: 0.999747803 (ground to grid)

1.00025226062 (grid to ground - City Datum)

	<u>Northing</u>	<u>Easting</u>	
<u>SPCS:</u>	1708054.0828	3125572.1525	
<u>City Datum:</u>	708484.9575	126360.6113	(Millions truncated in City Datum)
<u>Height:</u>	5372.10	US Feet (Adjusted)	

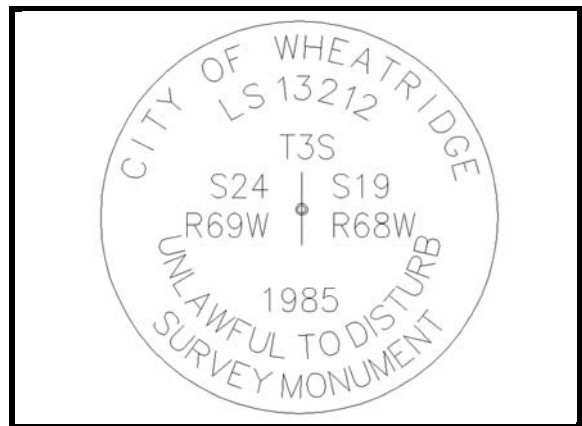

The monument is located in the City of Wheat Ridge, Colorado in the intersection of W. 44th Ave. and Sheridan Blvd.